

Exploded View

产品编码(Product model):

22023016002555

客户型号(Customer model):

MOVB-48HN1-M16L

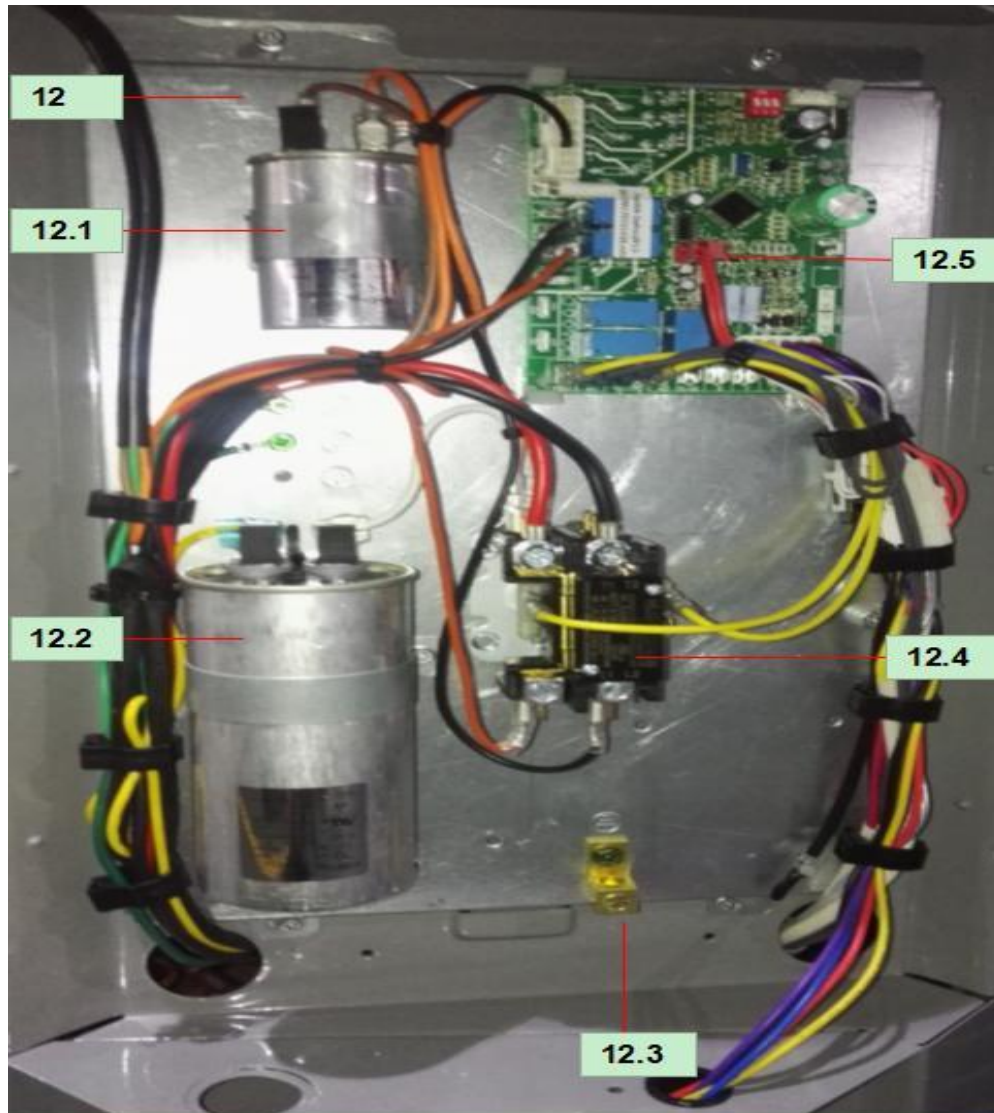

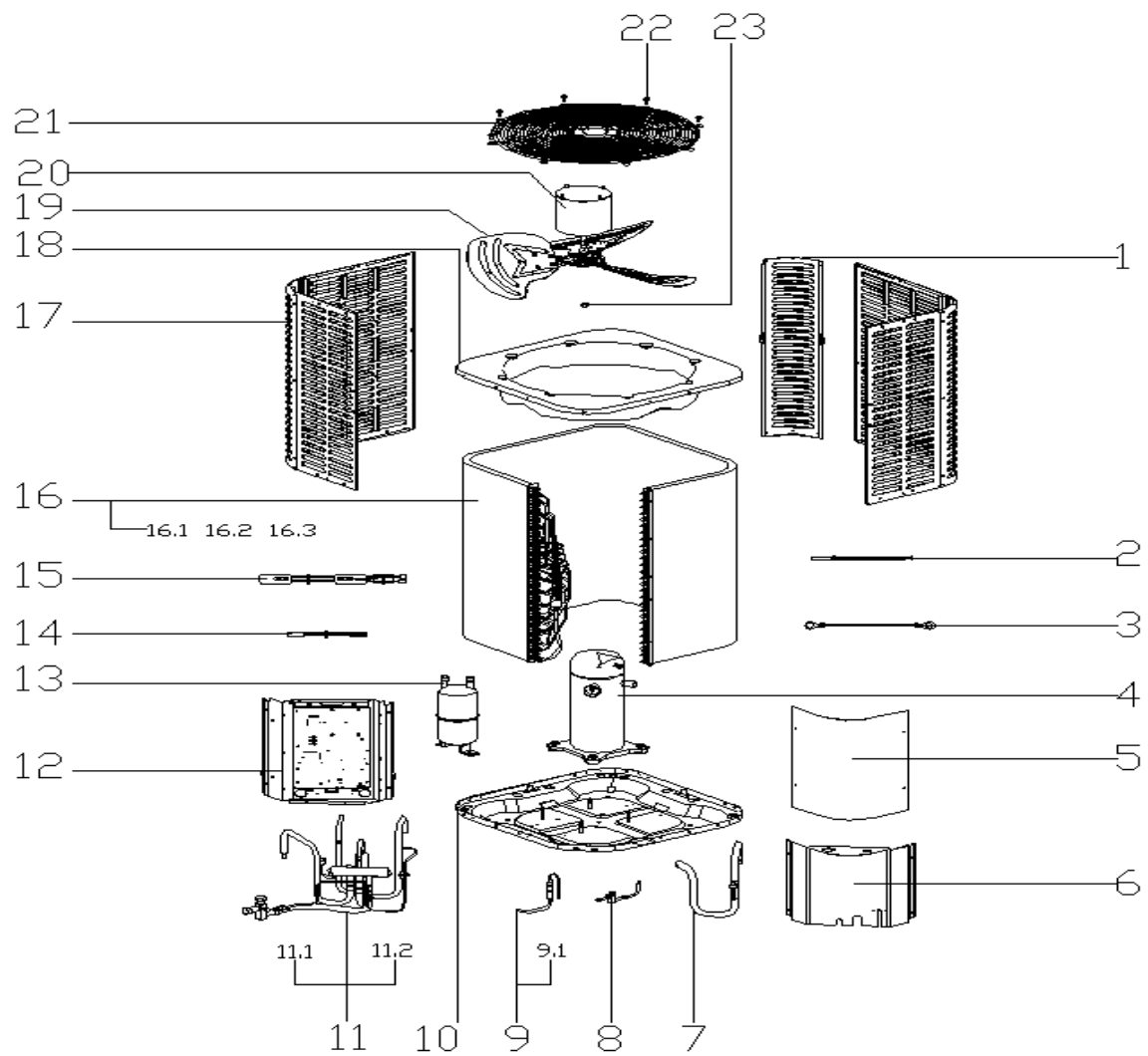

EX_ID	Spare Parts Code	Part Name(CN)	Part Name(EN)	Qty.	Remark2	Part Status	Drawing No
1	12223100000247	支撑板 SB3053 RoHS UL-KF140W/N1-543V3-1	Support Plate	3		In use	UL-KF140W/N1-543V3-1
2	11201007001782	管温传感器	Pipe Temperature Sensor	1	T3	In use	CGQ-WD/GW4100-L800-SMP3B
3	17401110000020	绿色接地线	Green ground line	1		In use	L700Φ2.1(aM4bM5)/UL1015-14-GN
4	11102010001185	定速涡旋式压缩机	Fixed speed scroll compressor	1		In use	ABG039KAC
5	12223100A00133	上侧板(SB3053)	Side board	1		In use	UL-KF53W/N1-411V3-6
6	12223100000349	下侧板部件(SB3053) RoHS UL-KF140W/N1-543V3.3 B H	Side board assembly, down	1		In use	UL-KF140W/N1-543V3.3
7	15423000004586	回气管组件	Suction pipe ass'y	1		In use	UL-KFR160W/N1-532V4E[L].ZL.3
7.1	17400516000149	压力控制器 RoHS YK-0.3/0.14-700(UL)	Pressure switch	1		In use	YK-0.3/0.14-700(UL)
8	15423000003178	高压阀组件	Stop valve ass'y	1		In use	UL-KF53W/N1-411V3.ZL.2A
9	15423000004858	节流阀组件	Throttle assembly	1		In use	UL-KFR140W/N1-532V6E[L].ZL.2
9.1	15500210000376	单向管道节流阀	Throttle	1		In use	JLF(H)-H068-GD-A
10	12223000002430	底盘部件(SB3053)	Base ass'y	1		In use	UL-KF105W/N1-531V3.1
11	15423000004824	四通阀组件	4-way valve ass'y	1		In use	UL-KFR140W/N1-532V6E[L].ZL.4
11.1	15423000004825	四通阀部件	4-way valve assembly	1		In use	UL-KFR140W/N1-532V6E[L].ZL.4.1
11.1.1	17400516000032	压力控制器	Pressure switch	1		In use	YK-4.4/3.2-600(UL)
11.1.2	15500206000017	方体阀	Block valve	1		In use	FTFM-05N1
11.2	15123000012067	表接头组件	Pipe joint ass'y	1		In use	UL-KFR105W/N1-531V4E[L].ZL.4.2A
12	17223000A05181	室外机电控盒组件	E-part box assembly	1		In use	UL-KFR140W/N1-543V4E[L].D.4(DZ)
12.1	17400103000151	压缩机电容	Capacitor	1		In use	15uF/450V-P2(2000h)
12.2	17400103000133	压缩机电容	Capacitor	1		In use	70uF/450V-P2(2000h)
12.3	11201708000008	接线柱 RoHS JXZH-CuH62-a6.6bM5	Wiring Terminal	1		In use	JXZH-CuH62-a6.6bM5
12.4	11203502000032	交流接触器	AC contactor 24V	1		In use	JCQ-40A-10-24VAC-L
12.5	17123000004815	室外主控板组件	Outdoor main control board assembly	1		In use	UL-WKR160A/MN1X-14B.D.2
13	15500508001115	贮液筒	Accumulator cylinder	1		In use	ZYT-03E(GT)A

14	17401203001230	压缩机连接线组	Compressor wire joint ass'y	1		In use	UL-KF160W/N1-532V3[L].D-1(LG:EAD36733405)
15	17402001000056	压缩机电加热带(带弹簧)	crankcase electric heater	1		In use	DJRD-510A-1300-30W
16	15823000004786	冷凝器部件	Condenser ass'y	1		In use	HVA-KF160W/N1-532V4E[C].ZL.1B
16.1	15823000004787	冷凝器	Condenser	1		In use	HVA-KF160W/N1-532V4E[C].ZL.1.1B
16.2	15123000010945	冷凝器输入管组件	Condenser inlet pipe ass'y	1		In use	UL-KFR140W/N1-543V4E[L].ZL.1.2
16.3	15423000004597	冷凝器输出管组件	Condenser outlet pipe ass'y	1		In use	UL-KFR140W/N1-543V4E[L].ZL.1.3
17	12223000004129	侧板组件 2(SB3053)	Clapboard ass'y 2	2		In use	UL-KF160W/N1-532V3.2B
17	12223100000361	侧板组件 1(SB3053)	sideboard	2		In use	UL-KF160W/N1-532V3.1
18	12223000001096	顶盖部件(SB3053)	Top cover ass'y	1		In use	HVA-KF105W/N1-531V3.1A
19	12200104000038	轴流风叶	Fan	1		In use	ZL-600*115*12.7-3N
20	11002012000741	单相异步电机	Motor	1		In use	YKS-230-6-17L
21	12227700003729	顶盖网罩(SB3023)	Top cover	1		In use	UL-WKR71A/MN1X-14A.1
22	11301002000001	六角头螺栓和弹簧垫圈及大垫圈组合件	Stainless steel bolts	8		In use	MJ16-00040
23	11301512000143	1 型六角螺母	Nut	1		In use	GBT6170