

(Midea CAC Exploded view)

MRD-36HWN1-M14G

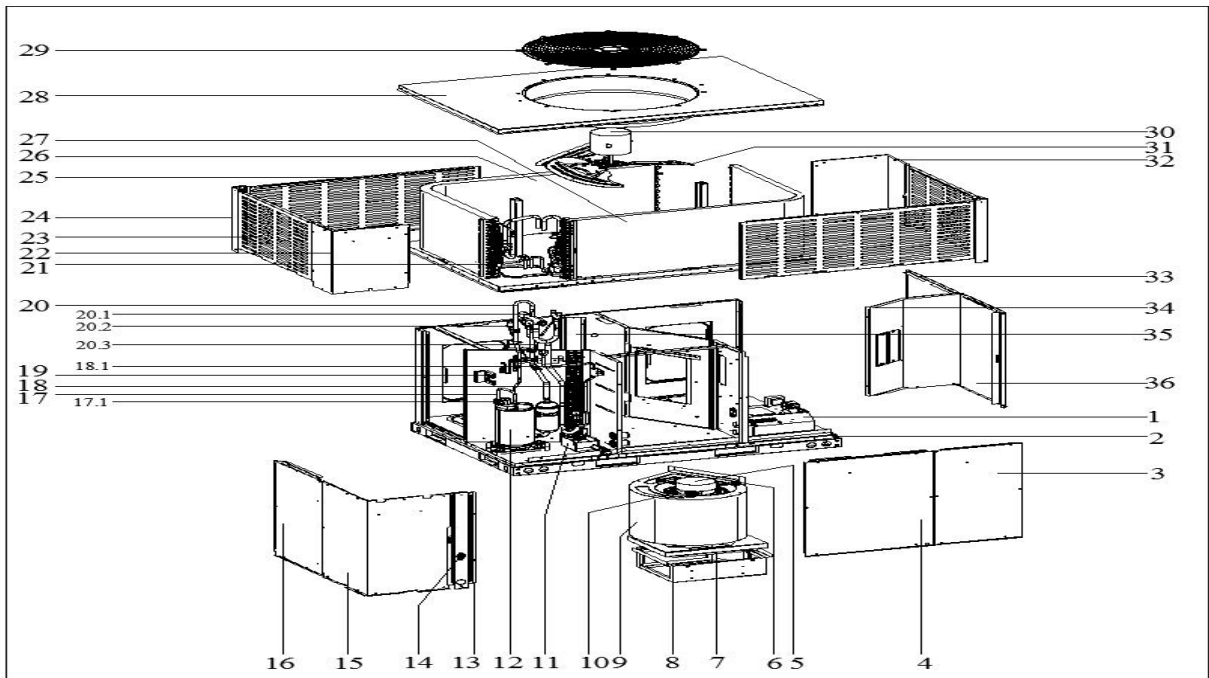
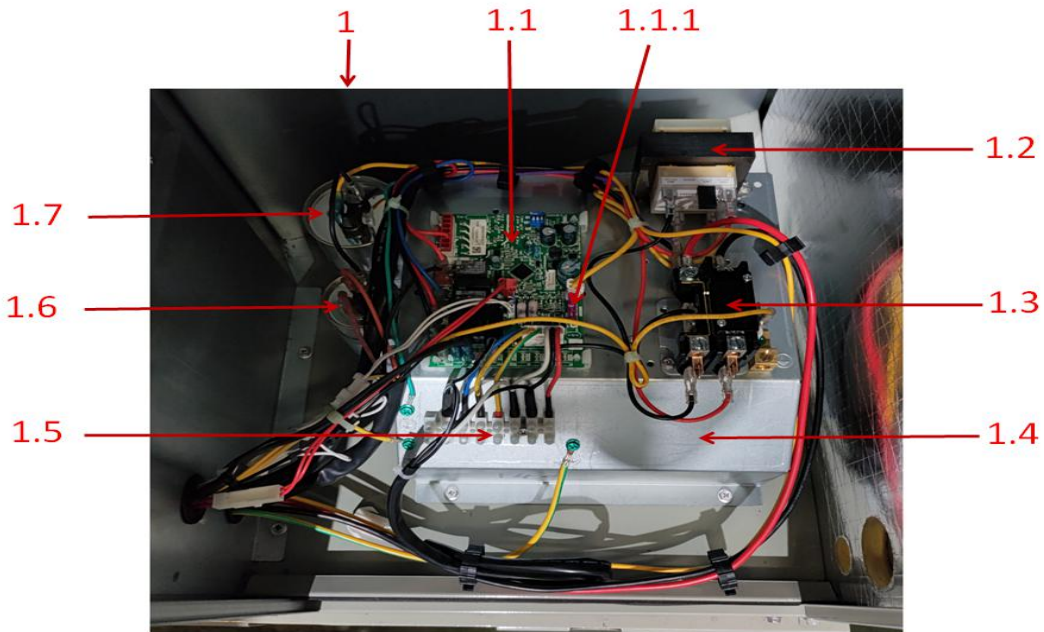

No.	Part Number	Part Name	Quantity
1	17227700000960	E-part box assembly	1
1.1	17127700000970	Main control board assemb	1.0
1.1.1	11203001001353	Fuse	1.0
1.2	11203103000194	Linear Transformer	1.0
1.3	11203502000032	AC contactor	1.0
1.4	12227700006629	Electrical appliance moun	1.0
1.5	17400401000196	Wire joint, 8P	1.0
1.6	17400103000152	Capacitor	1.0
1.7	17400103000138	Capacitor	1.0
2	12227700A06809	Chassis part	1
3	12227700A07187	Internal panel assembly	1
4	12227700A06873	Internal panel assembly	1
5	11002015011928	Brushless DC Motor	1

6	12223000001932	Supporter subassembly of	3
7	12227700006519	Wind wheel fixed plate	1
8	12227700006515	Fan support board	1
9	12200102000175	Centrifugal fan	1
10	12223000001992	Supporter of fan motor	1
11	12127700000117	Drainage pan assembly	1
12	11103010019040	Fixed speed rotary compres	1
13	12227700A07180	Column assembly	1
14	11201007000025	Room Temperature Sensor	1
15	12227700A06879	Panel	1
16	12227700A06854	Internal panel assembly	1
17	15427700001990	Air discharge pipe assemb	1
17.1	17400513000066	Discharge temp sensor	1
18	15427700001993	Throttle assembly	1
18.1	15500210004109	Throttle	1.0
19	12227700006741	Installation board	1
20	15427700002012	Four-way valve assembly	1
20.1	15500216000084	4-way valve	1.0
20.3	17400516000089	Pressure switch	1.0
21	11201007000412	Pipe Temperature Sensor	1
22	12227700A07120	Column assembly	1
23	12227700A06866	Protective plate assembly	2
24	12227700006740	Column	2
25	12227700A06877	Protective plate assembly	2
26	15827700000750	B unit condenser assembly	1
27	15827700000752	Condenser part	1
28	12227700A06875	Top cover welding assembl	1
29	12927700000341	protection net	1
30	11002012000506	Motor	1
31	12200104000038	Fan	1
32	12227700A06868	Column	1
33	12227700A06856	Internal panel assembly	1
34	12227700006518	Circuit board assembly du	1
35	15827700000748	Evaporator assembly	1
36	12227700A07191	Column assembly	1