

This document contains classified information.
 All individuals are strictly forbidden from any form of disclosure in whole or in part.
 Copy and/or distribution without expressed Midea consent is forbidden.

美的中央空调爆炸图 (Midea CAC Exploded view)

市场型号(Market model): MRB-48HWN1-X14
 产品型号(Product model): UL-WKR140AWN1X-14A
 产品编码(Product code): 22027710000061
 电源规格(Power supply): 208And230V_3Ph,FREQUENCY_60HZ 导出时间(Output time): 2017-04-17 10:15:01

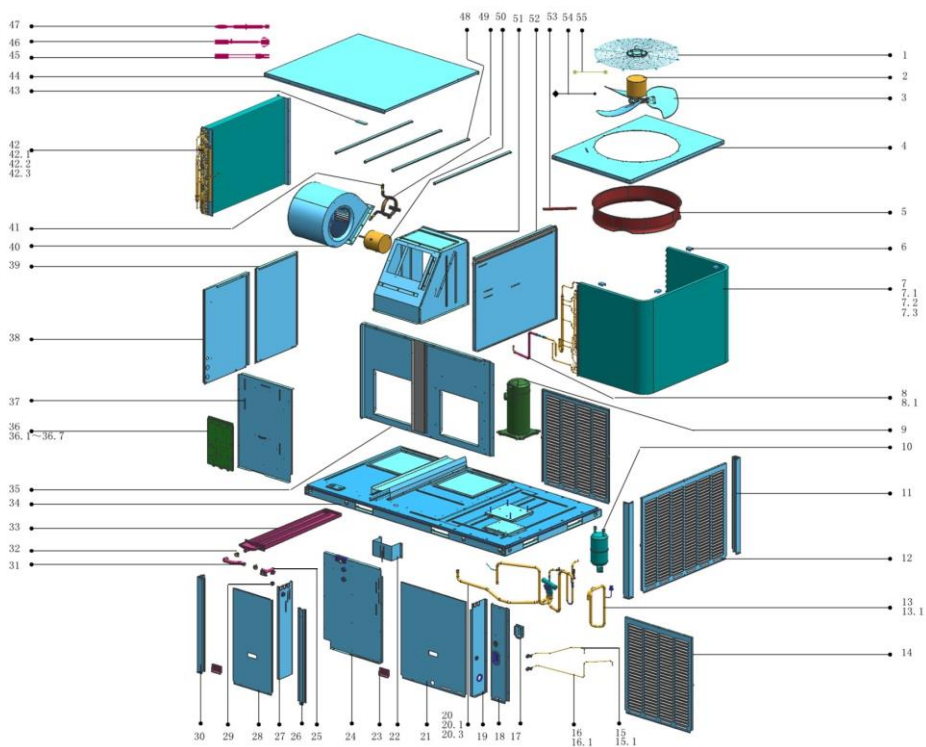
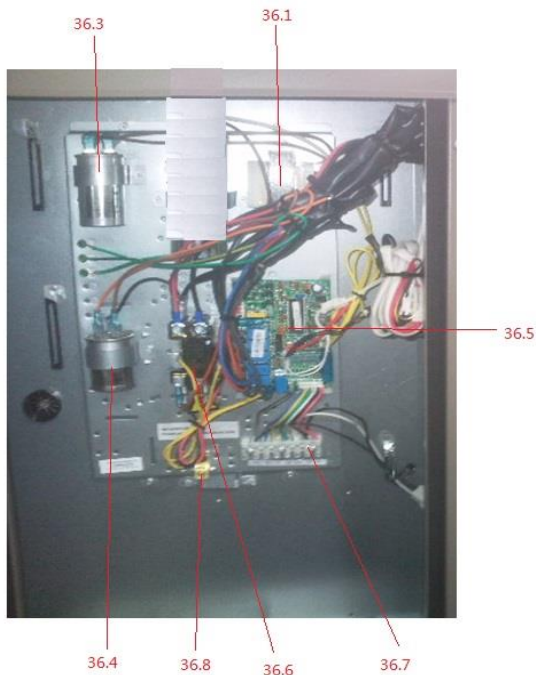

| 序号 | 零部件名称 | 数量 | 物料编码 | 价格 | 代号 |
|----|-------|----|------|----|----|
|----|-------|----|------|----|----|

| No. | Chinese Name | Part Name | Quantity | BOM Code | Price | Model |
|------|------------------|-----------------------------|----------|----------------|-------|-----------------|
| 1 | 顶盖网罩(SB3023) | Top cover | 1.0 | 12227700003729 | | UL-WKR71A/MN1X- |
| 2 | 单相异步电机 | Motor | 1.0 | 11002012002190 | | YKS-230-6-10 |
| 3 | 轴流风叶 | Fan | 1.0 | 12200104000038 | | ZL-600*115*12.7 |
| 4 | 外机顶盖焊合件(SB3053) | Top cover | 1.0 | 12227700000121 | | UL-WKR160A/MN1X |
| 5 | 导风圈 | Ventilation ring | 1.0 | 12123000000162 | | UL-KF105W/N1-53 |
| 6 | 冷凝器固定卡 | Fixing clamp, condenser | 4.0 | 12227700001945 | | UL-WKR160A/MN1X |
| 7 | 冷凝器部件 | Condenser ass'y | 1.0 | 15827700000164 | | UL-WKR160A/MN1X |
| 7.1 | 冷凝器 | Condenser | 1.0 | 15827700000093 | | UL-WKR160A/MN1X |
| 7.2 | 冷凝器输入管组件 | Condenser inlet pipe ass'y | 1.0 | 15127700000442 | | UL-WKR160A/MN1X |
| 7.3 | 冷凝器输出管组件 | Condenser output pipe ass'y | 1.0 | 15127700000464 | | UL-WKR160A/MN1X |
| 8 | 节流部件 | Throttle Parts | 1.0 | 15427700000088 | | UL-WKR140A/WN1X |
| 8.1 | 双向管道节流阀 | Two-way pipe throttle valve | 1.0 | 15500210000393 | | JLF(H)-070H/C08 |
| 9 | 定速涡旋式压缩机 | Fixed speed scroll compress | 1.0 | 11102010000264 | | 无图号 |
| 10 | 贮液筒 | accumulator cylinder | 1.0 | 15500508000018 | | ZYT-03E(GT) |
| 11 | 右立柱(SB3053) | Left pole | 2.0 | 12227700002642 | | UL-WKR160A/MN1X |
| 12 | 侧板1(SB3053) | clapboard | 1.0 | 12227700003209 | | UL-WKR160A/MN1X |
| 13 | 压缩机回气管组件 | Suction pipe ass'y | 1.0 | 15427700001070 | | UL-WKR160A/MN1X |
| 13.1 | 压力控制器 | Pressure switch | 1.0 | 17400516000089 | | YK-0.3/0.14-200 |
| 14 | 侧板2(SB3053) | clapboard | 2.0 | 12227700003211 | | UL-WKR160A/MN1X |
| 15 | 高压表接头组件 | Pipe joint ass'y | 1.0 | 15127700004606 | | UL-WKR160A/MN1X |
| 15.1 | 表接头 | Meter connector | 1.0 | 15500301000014 | | BJT-01AN1 |
| 16 | 低压表接头组件 | Low table connector compone | 2.0 | 15127700004600 | | UL-WKR160A/MN1X |
| 16.1 | 表接头 | Meter connector | 1.0 | 15500301000014 | | BJT-01AN1 |
| 17 | T4安装盒部件 | T4 Installation box parts | 1.0 | 12227700000504 | | UL-WKR160A/MN1X |
| 18 | 表接头安装盒连接板焊合件(SB | Pipe joint installation box | 1.0 | 12227700002436 | | UL-WKR160A/MN1X |
| 19 | 防水挡板组件 | Waterproof plate ass'y | 1.0 | 12227700001766 | | UL-WKR160A/MN1X |
| 20 | 四通阀组件 | 4-way valve ass'y | 1.0 | 15427700000531 | | UL-WKR160A/MN1X |
| 20.1 | 四通阀套件 | 4-way valve | 1.0 | 15500216000084 | | STF-03N1(UL)-24 |
| 20.3 | 压力控制器 | Pressure switch | 1.0 | 17400516000101 | | YK-4.4/3.2-2000 |
| 21 | 接水盘前盖板组件(SB3053) | middle clapboard ass'y | 1.0 | 12227700001767 | | UL-WKR160A/MN1X |
| 22 | 挡线板组件 | Plate ass'y, wires | 1.0 | 12227700000500 | | UL-WKR105A/MN1X |
| 23 | 提手(S3025) | Handle | 2.0 | 12100702000045 | | RF12WWC.1.4-2 |
| 24 | 蒸发器右连接板组件 | Connecting plate ass'y, eva | 1.0 | 12227700002257 | | UL-WKR160A/MN1X |
| 25 | 出水接头(黑色) | Drain connector | 1.0 | 12127700000012 | | UL-WKR71A/MN1X- |
| 26 | 中间立柱组件(SB3053) | Pole | 1.0 | 12227700002873 | | UL-WKR160A/MN1X |
| 27 | 电控隔板组件 | Clapboard, E-box | 1.0 | 12227700003573 | | UL-WKR160A/MN1X |
| 28 | 电控前盖板(SB3053) | Electronic front cover | 1.0 | 12227700003331 | | UL-WKR160A/MN1X |
| 29 | 封口塞 | seal plug | 1.0 | 15500402000023 | | UL-KF71V/X.2-9 |
| 30 | 左立柱组件(SB3053) | Pole | 1.0 | 12227700002922 | | UL-WKR160A/MN1X |
| 31 | 排水内连接管(黑色) | Connecting pipe, internal | 1.0 | 12627700000012 | | UL-WKR71A/MN1X- |
| 32 | 喉箍18-32 | Throat bander | 2.0 | 12200201000001 | | HG21-38 |
| 33 | 接水盘部件(黑色) | Drainage pan ass'y | 1.0 | 12127700000013 | | UL-WKR71A/MN1X- |
| 34 | 底盘部件(SB3053) | Base ass'y | 1.0 | 12227700000588 | | UL-WKR160A/MN1X |
| 35 | 送回风面板组件(SB3053) | Back to the panel kit | 1.0 | 12227700003313 | | UL-WKR160A/MN1X |
| 36 | 屋顶机电控盒组件 | E-part box ass'y | 1.0 | 17227700000117 | | UL-WKR140A/WN1X |
| 36.1 | 线性变压器 | Transformer | 1.0 | 11203103000142 | | TT220-EI66-24/2 |
| 36.3 | 压缩机电容 | Capacitor of compressor | 1.0 | 17400103000149 | | 20uF/450V-P2(20 |
| 36.4 | 压缩机电容 | Capacitor | 1.0 | 17400103000151 | | 15uF/450V-P2(20 |
| 36.5 | 室外主控板组件(插件)(中央) | Outdoor power board subasse | 1.0 | 17127700000125 | | UL-WKR105A/WN1X |
| 36.6 | 交流接触器 | 24V AC contactor | 1.0 | 11203502000029 | | JCQ-30A-30-24VA |
| 36.7 | 八位接线座 | Wire joint, 8P | 1.0 | 17400401000196 | | JXZ-P28Z |
| 36.8 | 接线柱 | Wiring Terminal | 1.0 | 11201708000008 | | JXZH-CuH62-a6.6 |
| 37 | 蒸发器左连接板组件 | Evaporator left linking slæ | 1.0 | 12227700002269 | | UL-WKR160A/MN1X |
| 38 | 回风侧板II组件(SB3053) | Return II lateral plate ass | 1.0 | 12227700003279 | | UL-WKR160A/MN1X |
| 39 | 回风侧板I组件(SB3053) | Return I lateral plate ass | 1.0 | 12227700003314 | | UL-WKR160A/MN1X |
| 40 | 离心风机 | Centrifugal fan | 1.0 | 12200102000027 | | LX-282*272*12.7 |
| 41 | 电机支架组件I | Supporter subassembly of fa | 3.0 | 12223000001932 | | UL-KF71V/N1X.16 |
| 42 | 蒸发器部件 | Evaporator ass'y | 1.0 | 15827700000309 | | UL-WKR160A/MN1X |
| 42.1 | 蒸发器 | Evaporator | 1.0 | 15827700000026 | | UL-WKR160A/MN1X |

| | | | | | |
|------|----------------|-----------------------------|-----|----------------|-----------------|
| 42.2 | 蒸发器输入管组件 | Input pipe ass'y | 1.0 | 15127700004658 | UL-WKR160A/MN1X |
| 42.3 | 蒸发器输出管组件 | Output pipe ass'y | 1.0 | 15127700003888 | UL-WKR160A/MN1X |
| 43 | 侧板支撑 | Supporting board | 1.0 | 12227700002604 | UL-WKR160A/MN1X |
| 44 | 内机顶盖组件(SB3053) | Top cover ass'y | 1.0 | 12227700000181 | UL-WKR160A/MN1X |
| 45 | 排气温控器 | Discharge temp sensor | 1.0 | 17400513000056 | PQWKQ-130/90-20 |
| 46 | 管温传感器 | Pipe Temperature Sensor | 1.0 | 11201007000165 | CGQ-WD/GW3450-L |
| 47 | 室温传感器 | Room Temperature Sensor | 1.0 | 11201007000195 | CGQ-WD/SW4100-L |
| 48 | 顶部横梁 | Beam | 4.0 | 12227700003635 | UL-WKR160A/MN1X |
| 49 | 电机支架 II | Supporter of fan motor | 1.0 | 12223000001992 | UL-KF71V/N1X-24 |
| 50 | 单相异步电机 | motor | 1.0 | 11002012001333 | YKS-400-6-6 |
| 51 | 风道部件 | Air channel ass'y | 1.0 | 12227700001421 | UL-WKR160A/MN1X |
| 52 | 内外机隔板组件 | Partition board ass'y | 1.0 | 12227700003622 | UL-WKR160A/MN1X |
| 53 | 过线导管 | Pipe | 1.0 | 12123000000252 | UL-KF90W/N1-541 |
| 54 | 压缩机连接线组 | Joint wires ass'y, compress | 1.0 | 17401203001139 | YSJ2100-D-RDU-W |
| 55 | 接地线(绿色) | Ground wire | 1.0 | 17401110000022 | L2000Φ2.1(AM5B) |

备注

Remark

