

This document contains classified information.  
 All individuals are strictly forbidden from any form of disclosure in whole or in part.  
 Copy and/or distribution without expressed Midea consent is forbidden.

### 美的中央空调爆炸图 (Midea CAC Exploded view)

市场型号(Market model): MRC-60HWN1-M14L  
 产品型号(Product model): UL-WKR160B/MN1X-14A  
 产品编码(Product code): 22027710000397  
 电源规格(Power supply): 208And230V\_1Ph,FREQUENCY\_60HZ 导出时间(Output time): 2017-04-17 10:21:34  
 50/50.1/50.2/50.3  
 /50.4/50.5/50.6  
 /50.7/50.8

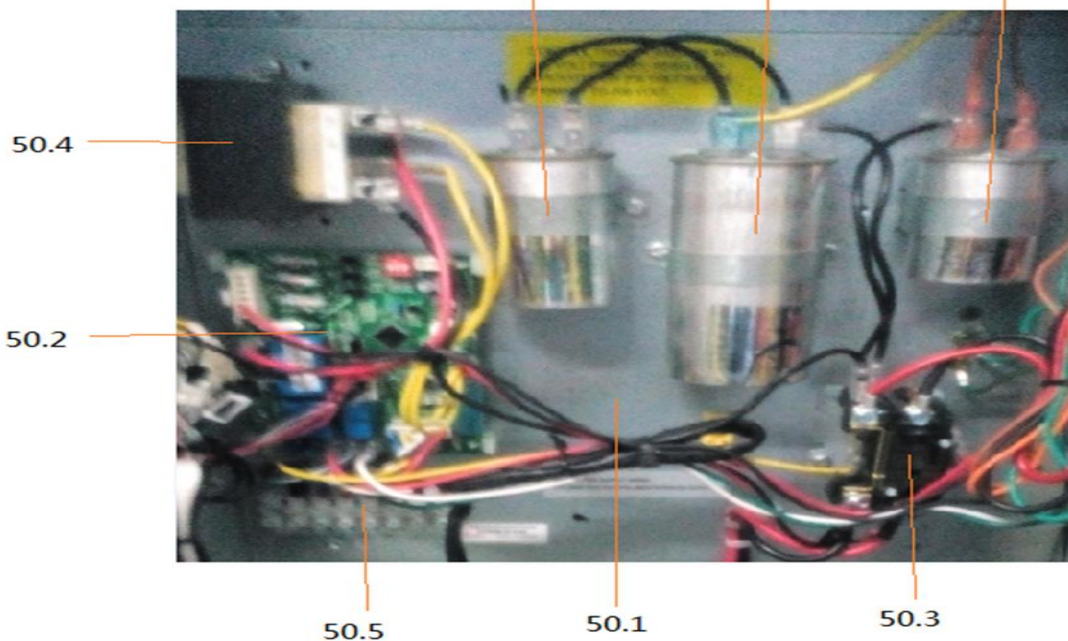
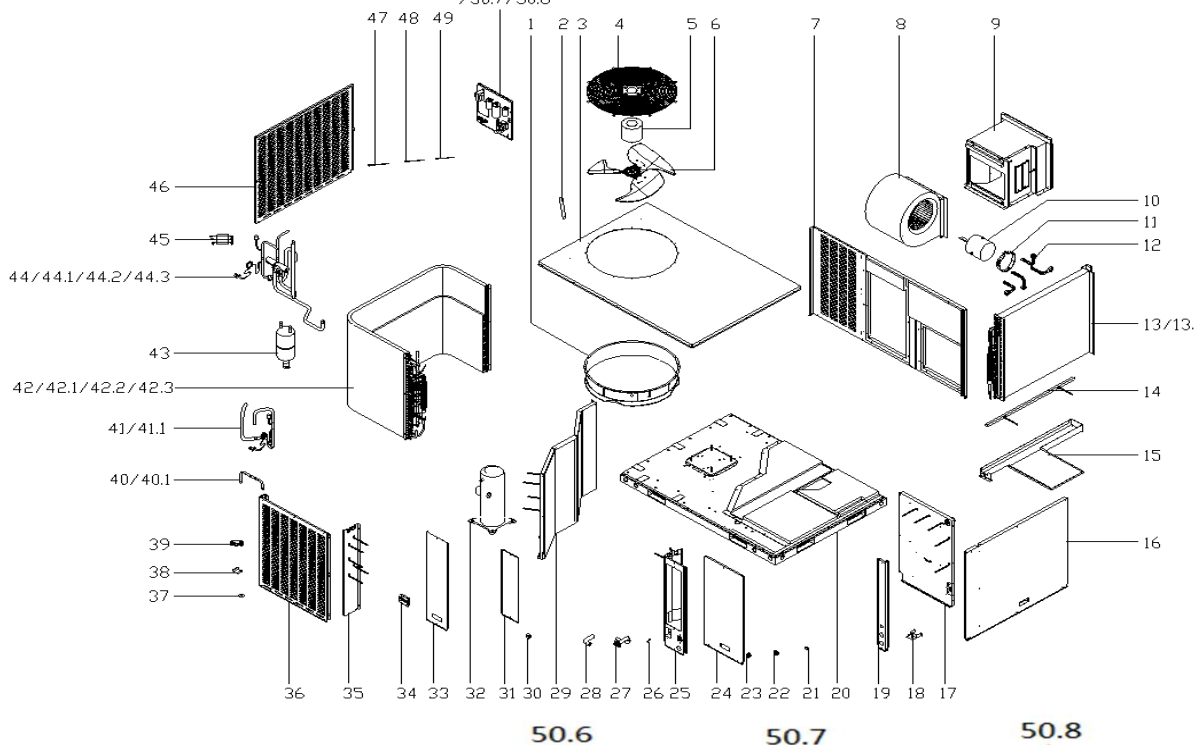

序号	零部件名称	数量	物料编码	价格	代号
----	-------	----	------	----	----

No.	Chinese Name	Part Name	Quantity	BOM Code	Price	Model
1	导风圈	Ventilation ring	1.0	1212300000162		UL-KF105W/N1-53
2	过线导管	Pipe	1.0	1212300000252		UL-KF90W/N1-541
3	顶盖组件(SB3074)	Top cover assembly	1.0	12227700004010		UL-WKR160B/MN1X
4	顶盖网罩(SB3023)	Top cover	1.0	12227700003729		UL-WKR71A/MN1X-
5	单相异步电机	Motor	1.0	11002012002190		YKS-230-6-10
6	轴流风叶	Fan	1.0	12200104000038		ZL-600*115*12.7
7	内侧面板组件(SB3074)	Panel assembly, interior	1.0	12227700004001		UL-WKR160B/MN1X
8	风轮部件	Centrifugal fan	1.0	12200101000053		LX-279*271*12.7
9	风道组件	Air channel ass'y	1.0	12227700003728		UL-WKR160B/MN1X
10	无刷直流电机	Brushless DC Motor	1.0	11002015001042		ZKSD-560-12-3
11	电机支架II	Motor bracket II	1.0	12223000001993		UL-KF160V/X-2
12	电机支架组件I	Supporter subassembly of fe	4.0	12223000001932		UL-KF71V/N1X.16
13	蒸发器部件	Evaporator ass'y	1.0	15827700000450		UL-WKR160B/MN1X
13.1	蒸发器(亲水/1.5)	Evaporator	1.0	15827700000451		UL-WKR160B/MN1X
13.2	蒸发器输入管组件	Input pipe ass'y	1.0	15127700004495		UL-WKR160B/MN1X
13.3	蒸发器输出管组件	Output pipe ass'y	1.0	15127700004112		UL-WKR160B/MN1X
13.4	蒸发器连接板组件	Condenser connection board	1.0	12227700003967		UL-WKR160B/MN1X
14	横梁焊合件	Beam assembly	1.0	12227700003996		UL-WKR160B/MN1X
15	接水盘组件(SB3074)	Drainage pan assembly	1.0	12227700003979		UL-WKR160B/MN1X
16	内侧面板组件(SB3074)	Panel assembly, interior	1.0	12227700003990		UL-WKR160B/MN1X
17	蒸发器连接板组件	Condenser connection board	1.0	12227700003993		UL-WKR160B/MN1X
18	挡线板焊合件	Line board assembly	1.0	12227700003986		UL-WKR160B/MN1X
19	立柱组件(SB3074)	Column ass'y	1.0	12227700003959		UL-WKR160B/MN1X
20	底盘部件	Base assembly	1.0	12227700004016		UL-WKR160B/MN1X
21	小过线圈	Wire clamp	1.0	12127700000003		CE-WK140/SX-A-1
22	过线胶圈	Wiring rubber ring	1.0	12100511000045		UL-GXQ-35
23	封口塞	seal plug	1.0	15500402000023		UL-KF71V/X.2-9
24	电控盒盖板(SB3074)	Cover, E-box	1.0	12227700003977		UL-WKR160B/MN1X
25	立柱组件(SB3074)	Pole assembly	1.0	12227700004006		UL-WKR160B/MN1X
26	电线卡扣(黑色,SR-F41)	Wiring snaps	1.0	12100304000002		UL-WKR160A/MN1X
27	出水接头(黑色)	Drain connector	1.0	12127700000012		UL-WKR71A/MN1X-
28	排水连接管(黑色)	Connecting pipe ass'y	1.0	12627700000016		UL-WKR160B/MN1X
29	中隔板组件	Partition board assembly	1.0	12227700003998		UL-WKR160B/MN1X
30	喉箍18-32	Throat bander	2.0	12200201000001		HG21-38
31	盖板(SB3074)	Cover	1.0	12227700003973		UL-WKR160B/MN1X
32	定速涡旋式压缩机	Fixed speed scroll compress	1.0	11102010000314		无图号
33	盖板(SB3074)	Cover	1.0	12227700003975		UL-WKR160B/MN1X
34	提手(S3025)	Handle	3.0	12100702000045		RF12WWC.1.4-2
35	中隔板焊合件	Partition board ass'y	1.0	12227700003988		UL-WKR160B/MN1X
36	防护板(SB3074)	preventer plate	1.0	12227700003969		UL-WKR160B/MN1X
37	压缩机脚垫	compressor feet base	4.0	12600401000024		KFR-43W-11S3L.J
38	冷凝器固定卡	Fixing clamp, condenser	4.0	12227700001945		UL-WKR160A/MN1X
39	整体自接式橡胶垫	Rubber pad	1.0	12600401000154		ZTZJSXJD-19(9)-
40	节流阀组件	Throttle valve ass'y	1.0	15427700000976		UL-WKR160B/MN1X
40.1	管道节流阀双向管道节流阀	Throttle valve	1.0	15500210000730		JLF(H)-070H/C09
41	回气管组件	Suction pipe ass'y	1.0	15427700000977		UL-WKR160B/MN1X
41.1	压力控制器	Pressure switch	1.0	17400516000089		YK-0.3/0.14-200
42	冷凝器部件	Condenser ass'y	1.0	15827700000452		UL-WKR160B/MN1X
42.1	冷凝器(亲水/1.3)	Condenser	1.0	15827700000453		UL-WKR160B/MN1X
42.2	冷凝器输入管组件	Input pipe ass'y	1.0	15127700004121		UL-WKR160B/MN1X
42.3	冷凝器输出管组件	Output pipe ass'y	1.0	15127700004438		UL-WKR160B/MN1X
43	贮液筒	accumulator cylinder	1.0	15500508000018		ZYT-03E(GT)
44	四通阀组件	4-way valve ass'y	1.0	15427700000978		UL-WKR160B/MN1X
44.1	四通阀套件	4-way valve	1.0	15500216000084		STF-03N1(UL)-24
44.2	压力控制器	Pressure switch	1.0	17400516000101		YK-4.4/3.2-2000
44.3	配重块	Clump weight	1.0	12600102000006		PZK-04
45	压缩机连接线组	Joint wires ass'y, compress	1.0	17401203001164		UL-WKC160A/MN1X
46	防护板(SB3074)	preventer plate	1.0	12227700003971		UL-WKR160B/MN1X
47	管温传感器	Pipe Temperature Sensor	1.0	11201007000412		CGQ-WD/GW4100-L

48	室温传感器	Room Temp. sensor ass'y	1.0	11201007000077	CGQ-WD/SW4100-L
49	接地线(绿色)	Ground wire	1.0	17401110000022	L2000Φ2.1(AM5B)
50	屋顶机电控盒组件	E-box ass'y	1.0	17227700000347	UL-WKR160B/MN1X
50.1	电器安装板	Installation board	1.0	122277000003962	UL-WKR105B/MN1X
50.2	屋顶机主控板组件	Main PCB board ass'y	1.0	17127700000372	UL-WKR71A/MN1X-
50.3	交流接触器	AC contactor 24V	1.0	11203502000032	JCQ-40A-10-24VA
50.4	线性变压器	Transformer	1.0	11203103000142	TT220-EI66-24/2
50.5	八位接线座	Wire joint, 8P	1.0	17400401000196	JXZ-PZ8Z
50.6	压缩机电容	Capacitor of compressor	1.0	17400103000149	20uF/450V-P2(20
50.7	压缩机电容	Capacitor	1.0	17400103000135	55uF/450V-P2(20
50.8	压缩机电容	Capacitor	1.0	17400103000151	15uF/450V-P2(20

1/13.2/13.3/13.4

备注

Remark

