

This document contains classified information.  
 All individuals are strictly forbidden from any form of disclosure in whole or in part.  
 Copy and/or distribution without expressed Midea consent is forbidden.

## 美的中央空调爆炸图 (Midea CAC Exploded view)

市场型号(Market model): MRB-36HWN1-M14  
 产品型号(Product model): UL-WKR105A/MN1X-14A  
 产品编码(Product code): 22027710000242  
 电源规格(Power supply): 208And230V\_1Ph,FREQUENCY\_60HZ 导出时间(Output time): 2017-04-17 10:12:42

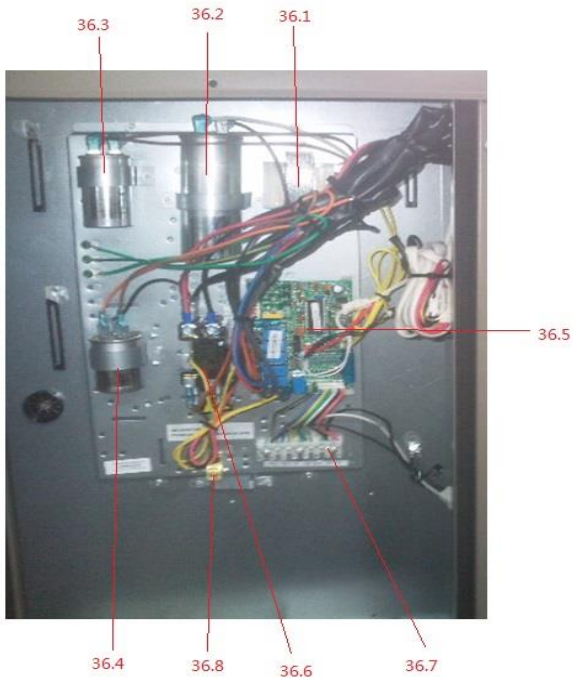
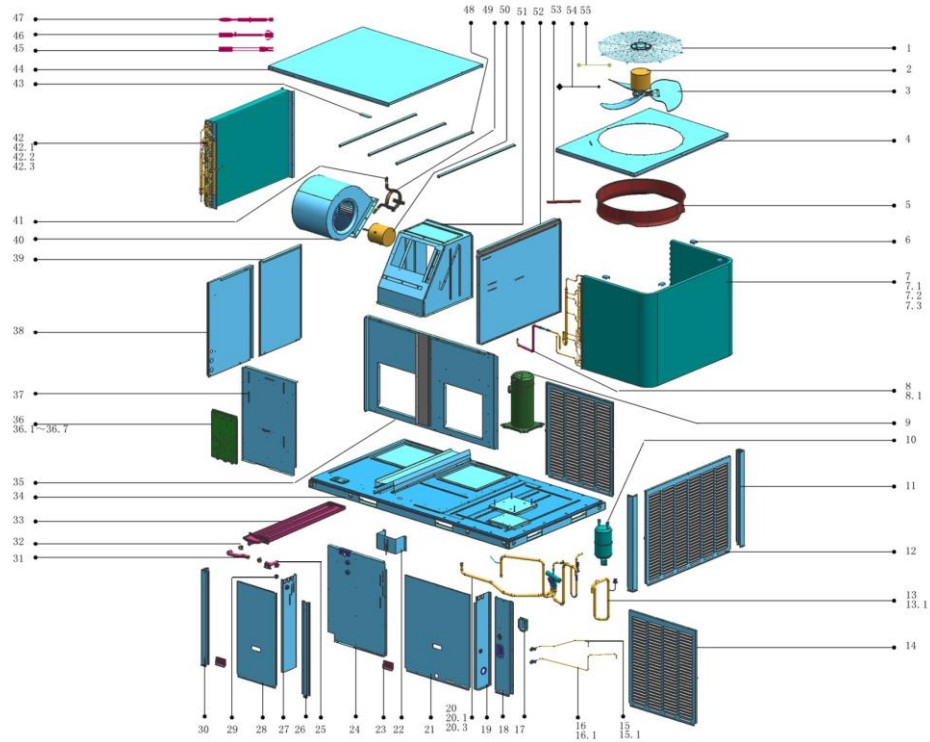

序号	零部件名称	数量	物料编码	价格	代号
----	-------	----	------	----	----

No.	Chinese Name	Part Name	Quantity	BOM Code	Price	Model
1	顶盖网罩(SB3023)	Top cover	1.0	12227700003729		UL-WKR71A/MN1X-
2	单相异步电机	Motor	1.0	11002012000506		YKS-110-8-6
3	轴流风叶	Fan	1.0	12200104000038		ZL-600*115*12.7
4	外机顶盖焊合件(SB3053)	Top cover	1.0	12227700000121		UL-WKR160A/MN1X
5	导风圈	Ventilation ring	1.0	12123000000162		UL-KF105W/N1-53
6	冷凝器固定卡(配1.5排Φ7冷凝	Condenser fixture clip	4.0	12223100000225		SA-KF71W-411V-2
7	冷凝器部件	Condenser ass'y	1.0	15827700000196		UL-WKR105A/MN1X
7.1	冷凝器(亲水/1.3)	Condenser	1.0	15827700000083		UL-WKR105A/MN1X
7.2	冷凝器输入管组件	Condenser inlet pipe ass'y	1.0	15127700000502		UL-WKR105A/MN1X
7.3	冷凝器输出管组件	Condenser output pipe ass'y	1.0	15127700000464		UL-WKR105A/MN1X
8	节流部件	throttle ass'y	1.0	154277000001074		UL-WKR105A/MN1X
8.1	双向管道节流阀	Two-way pipe throttle valve	1.0	15500210000392		JLF(H)-053H/C06
9	定速涡旋式压缩机	Fixed speed scroll compress	1.0	11102010000252		ZP31K5E-PFV-130
10	贮液筒	Accumulator cylinder	1.0	15500508000082		ZYT-03E11EL
11	右立柱(SB3053)	Pole	2.0	122277000002665		UL-WKR105A/MN1X
12	侧板1(SB3053)	Gridding	1.0	122277000003236		UL-WKR105A/MN1X
13	压缩机回气管组件	Suction pipe ass'y	1.0	154277000001072		UL-WKR105A/MN1X
13.1	压力控制器	Pressure switch	1.0	17400516000089		YK-0.3/0.14-200
14	侧板2(SB3053)	Pole	2.0	122277000003327		UL-WKR105A/MN1X
15	高压表接头组件	Pipe joint ass'y	1.0	151277000004605		UL-WKR105A/MN1X
15.1	表接头	Meter connector	1.0	15500301000014		BJT-01AN1
16	低压表接头组件	Pipe joint ass'y	1.0	151277000004601		UL-WKR105A/MN1X
16.1	表接头	Meter connector	1.0	15500301000014		BJT-01AN1
17	T4安装盒部件	T4 Installation box parts	1.0	122277000000504		UL-WKR160A/MN1X
18	表接头安装盒连接板焊合件(SB	Pole	1.0	122277000002440		UL-WKR105A/MN1X
19	防水挡板组件	waterproof clapboard ass'y	1.0	122277000001776		UL-WKR105A/MN1X
20	四通阀组件	4-way valve ass'y	1.0	15427700000557		UL-WKR105A/MN1X
20.1	四通阀套件	4-way valve	1.0	15500216000084		STF-03N1(UL)-24
20.3	压力控制器	Pressure switch	1.0	174005160000101		YK-4.4/3.2-2000
21	接水盘前盖板组件(SB3053)	Front cover plate ass'y	1.0	122277000001778		UL-WKR105A/MN1X
22	挡线板组件	Plate ass'y, wires	1.0	12227700000500		UL-WKR105A/MN1X
23	提手(S3025)	Handle	2.0	12100702000045		RF12WWC.1.4-2
24	蒸发器右连接板组件	Evaporator right clapboard	1.0	122277000002244		UL-WKR105A/MN1X
25	出水接头(黑色)	Drain connector	1.0	121277000000012		UL-WKR71A/MN1X-
26	中间立柱组件(SB3053)	Pole ass'y	1.0	122277000002863		UL-WKR105A/MN1X
27	电控隔板组件	E-part box board ass'y	1.0	122277000003590		UL-WKR105A/MN1X
28	电控前盖板(SB3053)	Front cover	1.0	122277000003074		UL-WKR105A/MN1X
29	封口塞	seal plug	1.0	15500402000023		UL-KF71V/X.2-9
30	左立柱组件(SB3053)	pole ass'y	1.0	122277000002913		UL-WKR105A/MN1X
31	排水内连接管(黑色)	Connecting pipe, internal	1.0	126277000000012		UL-WKR71A/MN1X-
32	喉箍18-32	Throat bander	2.0	12200201000001		HG21-38
33	接水盘部件(黑色)	Drainage pan ass'y	1.0	121277000000013		UL-WKR71A/MN1X-
34	底盘部件(SB3053)	Base ass'y	1.0	12227700000588		UL-WKR160A/MN1X
35	送回风面板组件(SB3053)	Panel ass'y	1.0	122277000003280		UL-WKR105A/MN1X
36	屋顶机电控盒组件	E-part box ass'y	1.0	172277000000028		UL-WKR105A/MN1X
36.1	线性变压器	Transformer	1.0	11203103000142		TT220-EI66-24/2
36.2	压缩机电容	Capacitor	1.0	174001030000150		45uF/450V-P2(20
36.3	压缩机电容	Capacitor of compressor	1.0	174001030000154		10uF/450V-P2(20
36.4	压缩机电容	Capacitor	1.0	174001030000152		6uF/450V-P2(200
36.5	室外主控板组件(插件)(中央)	Outdoor power board subasse	1.0	171277000000095		UL-WKR105A/MN1X
36.6	交流接触器	AC contactor 24V	1.0	11203502000032		JCQ-40A-10-24VA
36.7	八位接线座	Wire joint, 8P	1.0	17400401000196		JXZ-P28Z
36.8	接线柱	Wiring Terminal	1.0	112017080000008		JXZH-CuH62-a6.6
37	蒸发器左连接板组件	Evaporator left clapboard a	1.0	122277000001964		UL-WKR105A/MN1X
38	回风侧板II组件(SB3053)	cover ass'y II	1.0	122277000003299		UL-WKR105A/MN1X
39	回风侧板I组件(SB3053)	cover ass'y I	1.0	122277000003298		UL-WKR105A/MN1X
40	离心风机	Centrifugal fan	1.0	122001020000027		LX-282*272*12.7
41	电机支架组件I	Supporter subassembly of f	3.0	122230000001932		UL-KF71V/N1X.16
42	蒸发器部件	Evaporator ass'y	1.0	158277000000362		UL-WKR105A/MN1X

42.1	蒸发器(亲水/1.6)	Evaporator	1.0	15827700000024	UL-WKR105A/MN1X
42.2	蒸发器输入管组件	Evaporator input pipe ass'y	1.0	15127700004659	UL-WKR105A/MN1X
42.3	蒸发器输出管组件	Evaporator output pipe ass'y	1.0	15127700003966	UL-WKR105A/MN1X
43	侧板支撑	Supporting board	1.0	12227700002604	UL-WKR160A/MN1X
44	内机顶盖组件(SB3053)	Top cover ass'y	1.0	12227700000181	UL-WKR160A/MN1X
45	排气温控器	Discharge temp sensor	1.0	17400513000056	PQWKQ-130/90-20
46	管温传感器	Pipe Temperature Sensor	1.0	11201007000165	CGQ-WD/GW3450-L
47	室温传感器	Room Temperature Sensor	1.0	11201007000195	CGQ-WD/SW4100-L
48	顶部横梁	Beam	4.0	12227700003635	UL-WKR160A/MN1X
49	电机支架 II	Supporter of fan motor	1.0	12223000001992	UL-KF71V/N1X-24
50	单相异步电机	Motor	1.0	11002012001564	YKS-270-6-8
51	风道部件	Duct components	1.0	12227700001417	UL-WKR71A/MN1X-
52	内外机隔板组件	Partition board ass'y	1.0	12227700003608	UL-WKR105A/MN1X
53	过线导管	Pipe	1.0	12123000000252	UL-KF90W/N1-541
54	压缩机连接线组	Compressor wire joint ass'y	1.0	17401203001268	YSJ2100-D-RDU-W
55	接地线(绿色)	Ground wire	1.0	17401110000022	L2000Φ2.1(AM5B)

备注

Remark

