

Market model: MRB-36HWN1-X14B

product code: 220096000650

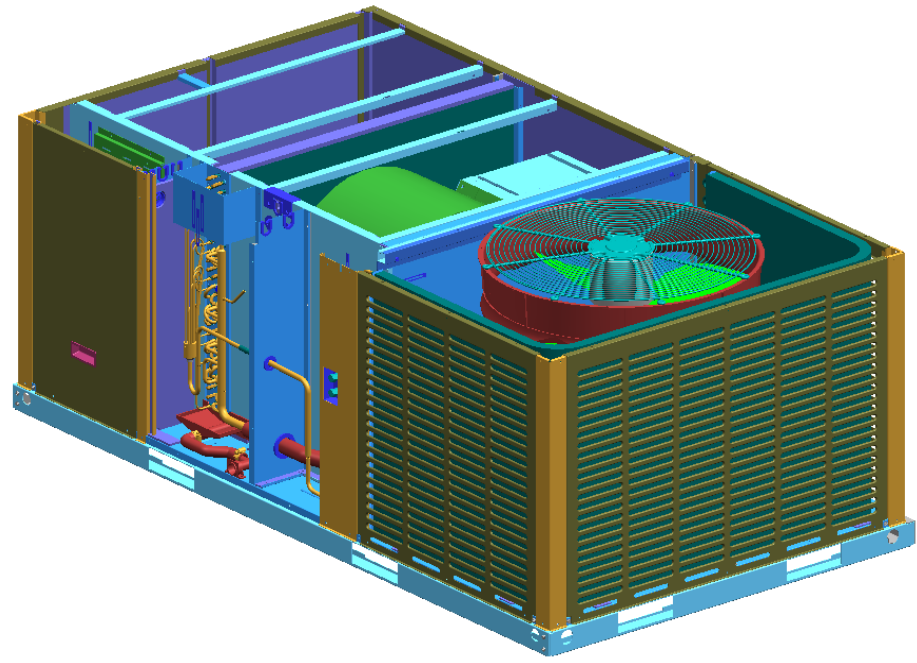

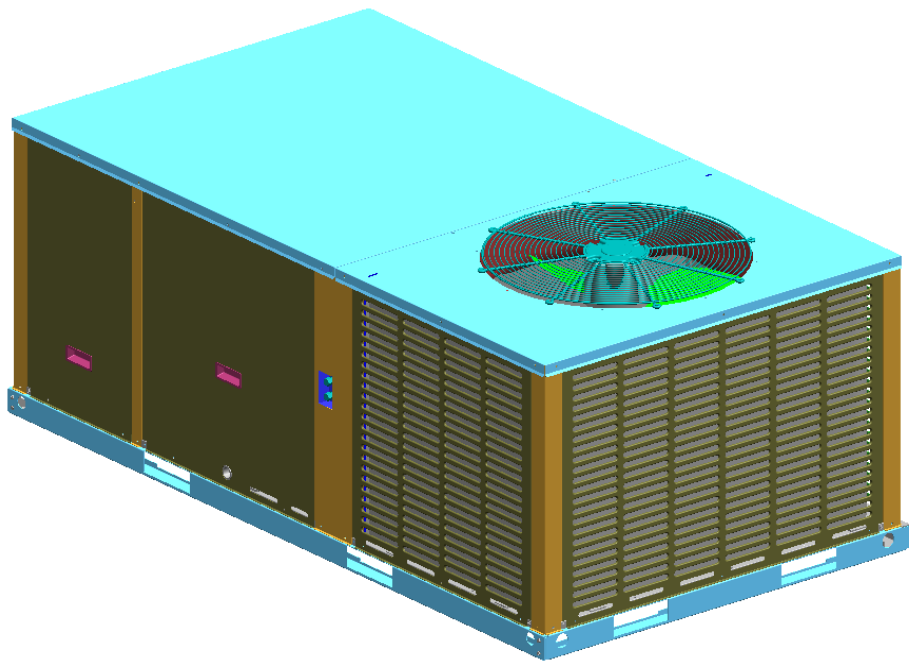

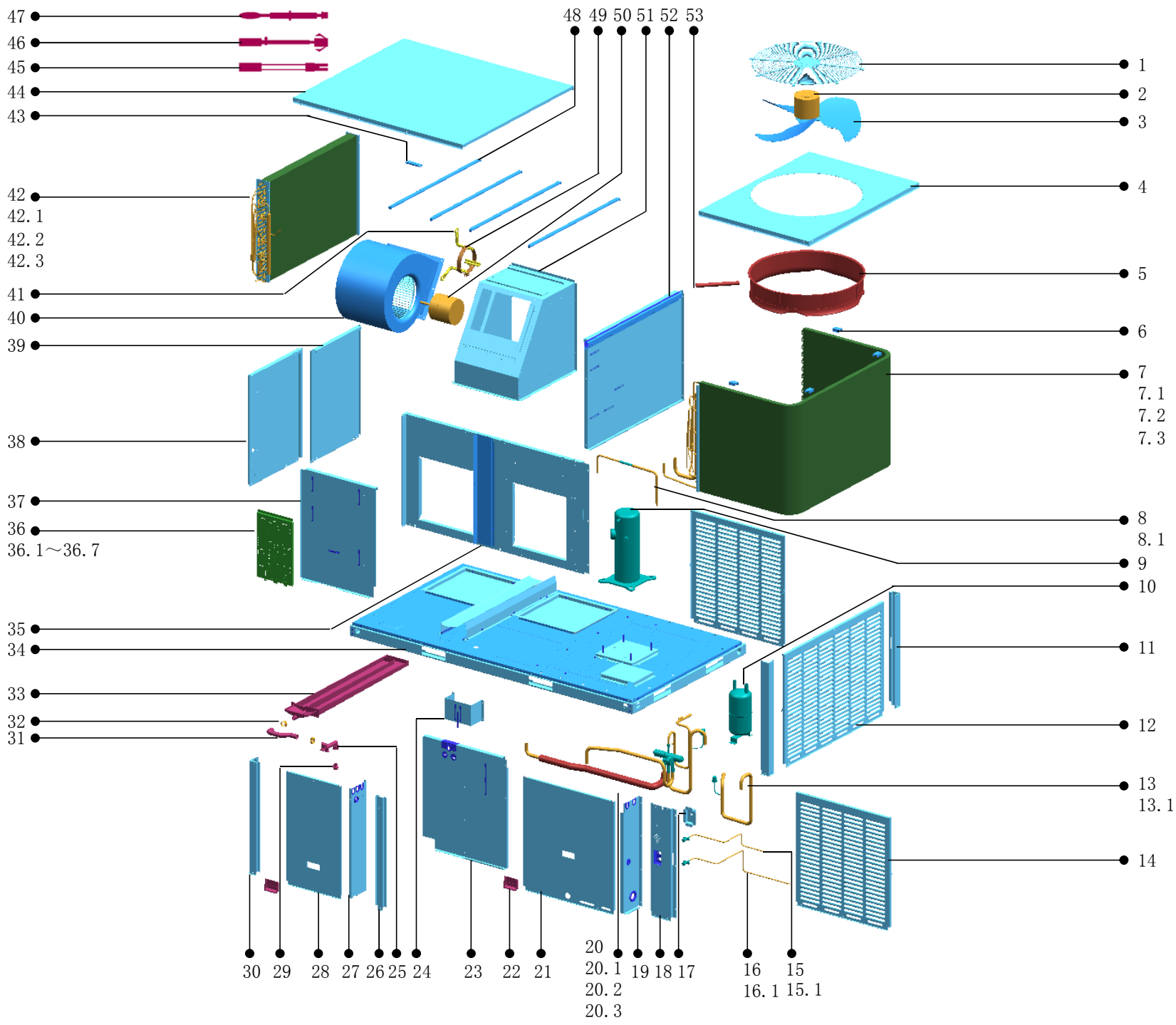
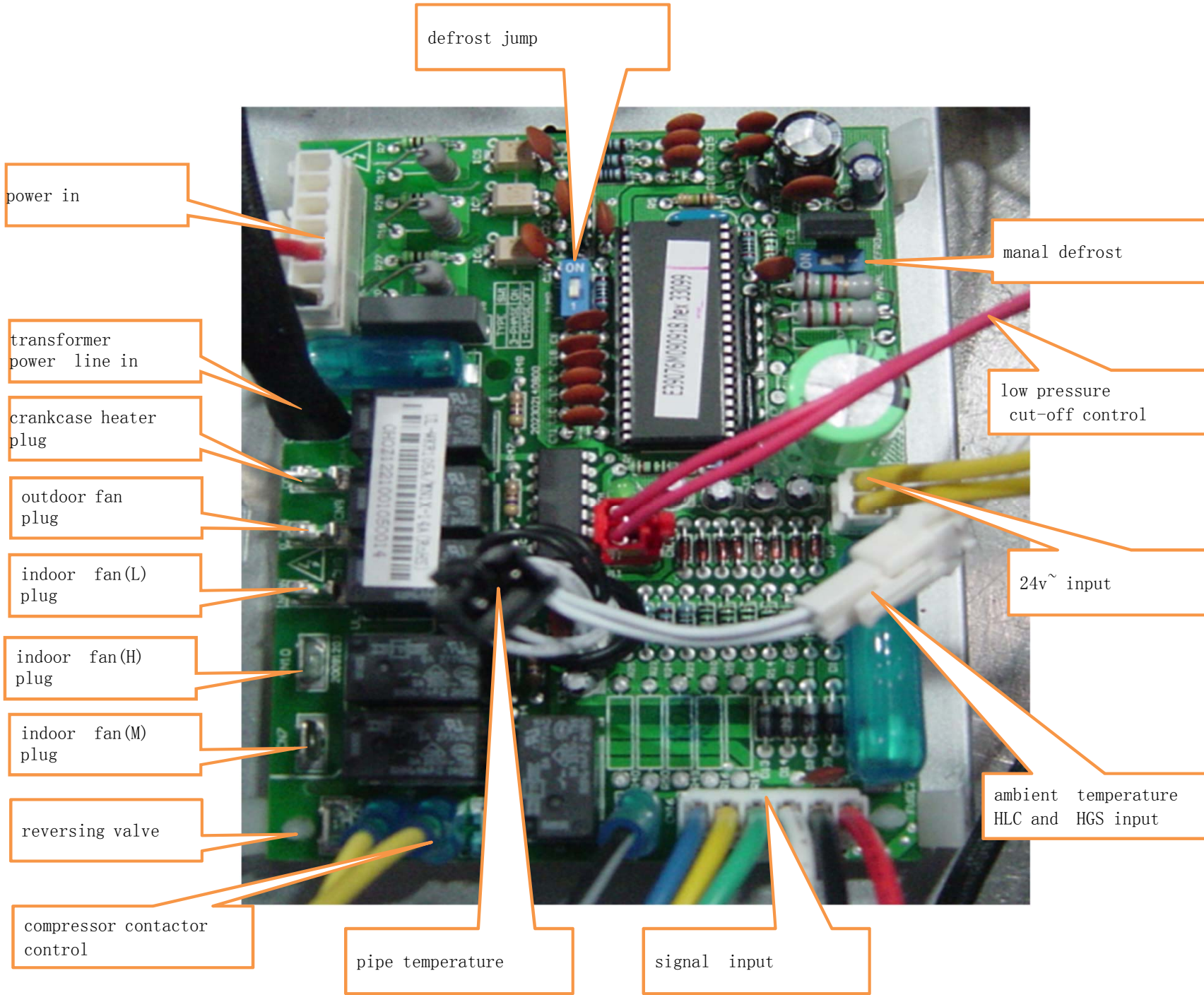

No.	中文	Part Name	Quantity	BOM code	Price(\$)	Remark
1	顶盖网罩(SB3023, RoHS)	Top cover veil	1	201296090213		
2	异步电机(RoHS)	Motor	1	202400400654		
3	轴流风叶(RoHS)	Fan, 3 blade count, aluminum alloy + gal	1	201200300245		
4	外机顶盖焊合件(SB3053, RoHS)	Top cover	1	201296090231		
5	导风圈(RoHS)	Ring	1	201175590009		
6	冷凝器固定卡(配1.5排Φ7)	Fixture clip	4	201275390114		
7	冷凝器部件(RoHS)	Condenser ass'y	1	201596090051		
7.1	冷凝器(亲水/1.3, RoHS)	Condenser	1	201596090052		
7.2	冷凝器输入管组件(RoHS)	Input tube condenser of components	1	201696090510		
7.3	冷凝器输出管组件(RoHS)	The condenser output tube assemblies	1	201696090502		
8	节流部件(RoHS)	Throttle ass'y	1	201696090520		
8.1	双向管道节流阀(RoHS)	Two-way pipe throttle valve	1	201600801306		
9	压缩机(谷轮)(RoHS)	Compressor	1	201401400290		
10	贮液筒(RoHS)	Accumulator cylinder	1	201601000563		
11	右立柱(SB3053, RoHS)	Pole	2	201296090303		
12	侧板1(SB3053, RoHS)	Gridding	1	201296090312		
13	压缩机回气管组件(RoHS)	Components of the compressor back to	1	201696090553		
13.1	压力控制器(RoHS)	Pressure switch	1	202301800837		
14	侧板2(SB3053, RoHS)	Pole	2	201296090311		
15	高压表接头组件(RoHS)	Pipe joint ass'y	1	201696090189		
15.1	表接头(RoHS)	Pipe joint	1	201601200011		
16	低压表接头组件(RoHS)	Pipe joint ass'y	1	201696090305		
16.1	表接头(RoHS)	Pipe joint	1	201601200011		
17	T4安装盒部件	T4 Installation box parts	1	201296090124		
18	表接头安装盒连接板焊合件	Pole	1	201296090126		
19	防水挡板组件(RoHS)	waterproof clapboard ass'y	1	201296090297		
20	四通阀组件(RoHS)	4-way valve ass'y	1	201696090518		
20.1	四通阀套件(RoHS)	4-Ways valve	1	201600630620		
20.2	压力控制器(RoHS)	Pressure switch	1	202301800836		
21	接水盘前盖板组件(SB3053, RoHS)	Front cover plate ass'y	1	201296090309		
22	提手(S3025)(RoHS)	Handle	2	201148700003		
23	蒸发器右连接板组件(RoHS)	Evaporator right clapboard ass'y	1	201296090280		
24	挡线板组件(RoHS)	Baffle ass'y	1	201296090208		
25	出水接头(黑色, RoHS)	Water outlet joint	1	201196090002		
26	中间立柱组件(SB3053, RoHS)	Pole ass'y	1	201296090299		
27	电控隔板组件(RoHS)	E-part box board ass'y	1	201296090304		
28	电控前盖板(SB3053, RoHS)	Front cover	1	201296090279		
29	封口塞(RoHS)	Sealing plug	1	201170390002		
30	左立柱组件(SB3053, RoHS)	pole ass'y	1	201296090301		
31	排水内连接管(黑色, RoHS)	Connecting pipe	1	202796090005		
32	喉箍18-32(RoHS)	Throat bander	2	202900240000		
33	接水盘部件(黑色, RoHS)	Drainage pan ass'y	1	201196090004		
34	底盘部件(SB3053, RoHS)	Base ass'y	1	201296090260		
35	送回风面板组件(SB3053, RoHS)	Panel ass'y	1	201296090290		
36	屋顶机电控盒组件	E-part box ass'y	1	203396090036		
36.1	电源变压器(无保险丝60Hz)	Transformer	1	202300900223		
36.2	压缩机电容(RoHS)	Compressor capacitor	1	202401000893		
36.3	室外主控板组件(插件, RoHS)	Outdoor control board assembly	1	201396090008		
36.5	交流接触器24V(RoHS)	24V AC contactor	1	202300830526		
36.6	八位接线座(RoHS)	Wire joint, 8p	1	202301400226		

36.7	压缩机电容 (RoHS)	Capacitor	1	202401000891		
37	蒸发器左连接板组件 (RoHS)	Evaporator left clapboard ass'y	1	201296090283		
38	回风侧板 II 组件 (SB3053, RoHS)	cover ass'y II	1	201296090295		
39	回风侧板 I 组件 (SB3053, RoHS)	cover ass'y I	1	201296090293		
40	离心风机 (RoHS)	Centrifugal fan	1	201200300211		
41	电机支架组件 I (RoHS)	Motor bracket I	3	201270390288		
42	蒸发器部件 (RoHS)	Evaporator ass'y	1	201596090036		
42.1	蒸发器 (亲水/1.6, RoHS)	Evaporator	1	201596090038		
42.2	蒸发器输入管组件 (RoHS)	Evaporator input pipe ass'y	1	201696090340		
42.3	蒸发器输出管组件 (RoHS)	Evaporator output pipe ass'y	1	201696090353		
43	侧板支撑 (RoHS)	Clapboard supporting board	1	201296090225		
44	内机顶盖组件 (SB3053, RoHS)	Top cover ass'y	1	201296090233		
45	排气温控器 (RoHS)	Discharge Temp. sensor	1	202301610027		
46	管温传感器组件 (商用) (RoHS)	Pipe Temp. sensor ass'y	1	202301300438		
47	室温传感器组件 (商用) (RoHS)	Room Temp. sensor ass'y	1	202301300198		
48	顶部横梁 (RoHS)	beam	4	201296090227		
49	电机支架 II (RoHS)	Motor bracket II	1	201270390273		
50	异步电机 (RoHS)	Motor	1	202400400653		
51	风道部件 (RoHS)	Baffle ass'y	1	201296090252		
52	内外机隔板组件 (RoHS)	Partition board ass'y	1	201296090287		
53	过线导管 (RoHS)	Pipe	1	201175490001		