

MRB-30S060GWN1-M14

220096001260

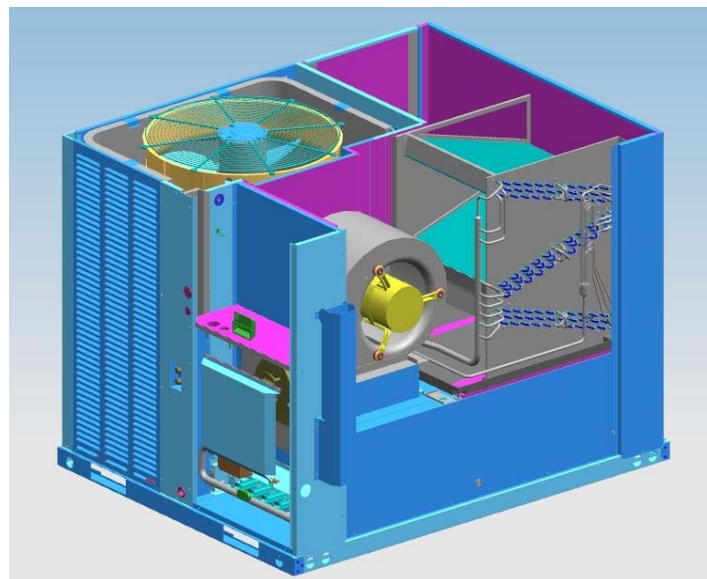

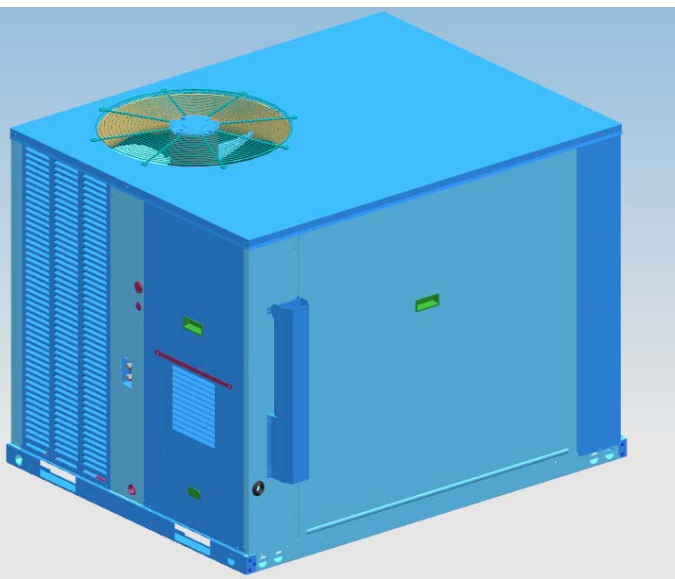
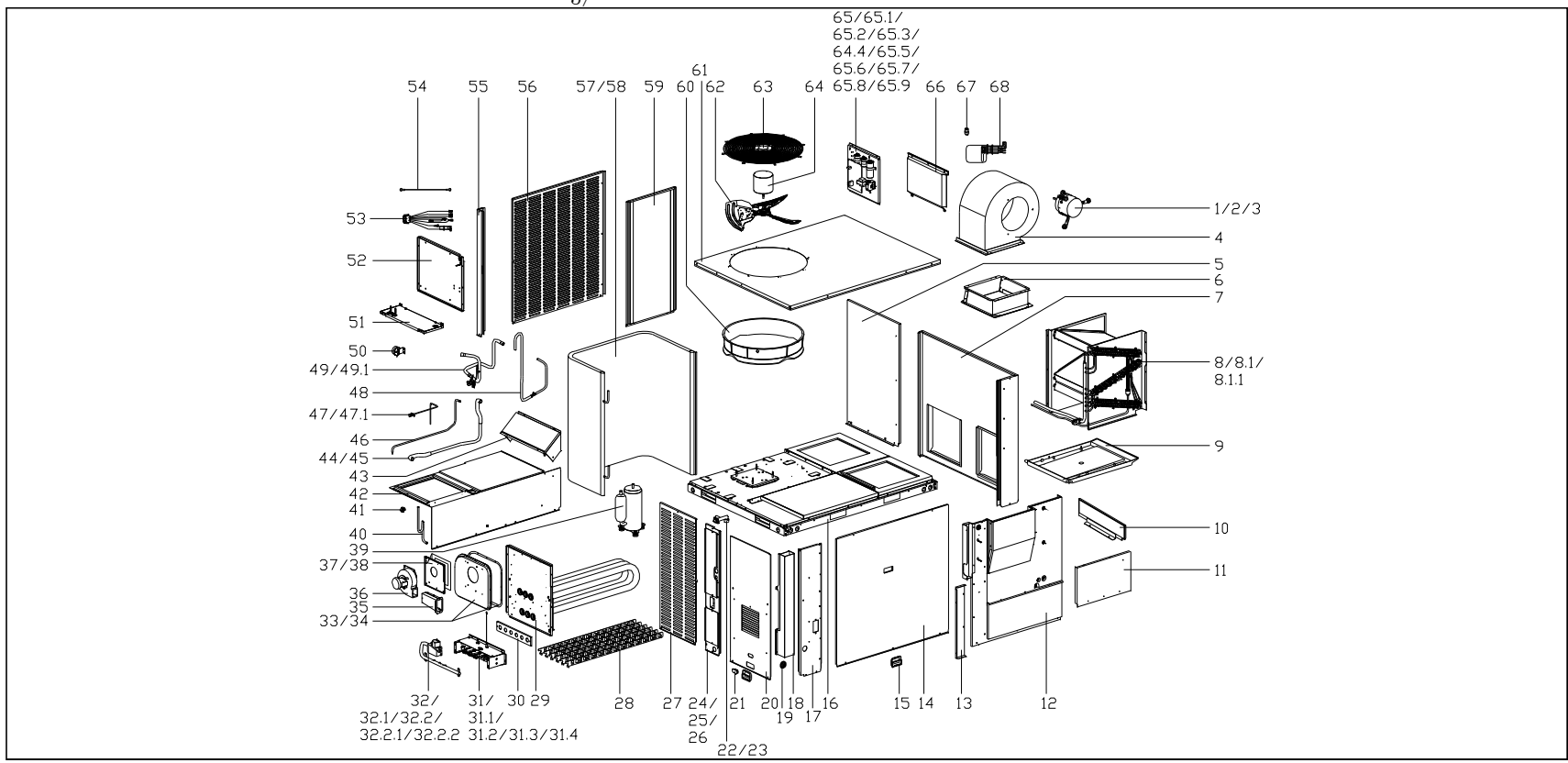
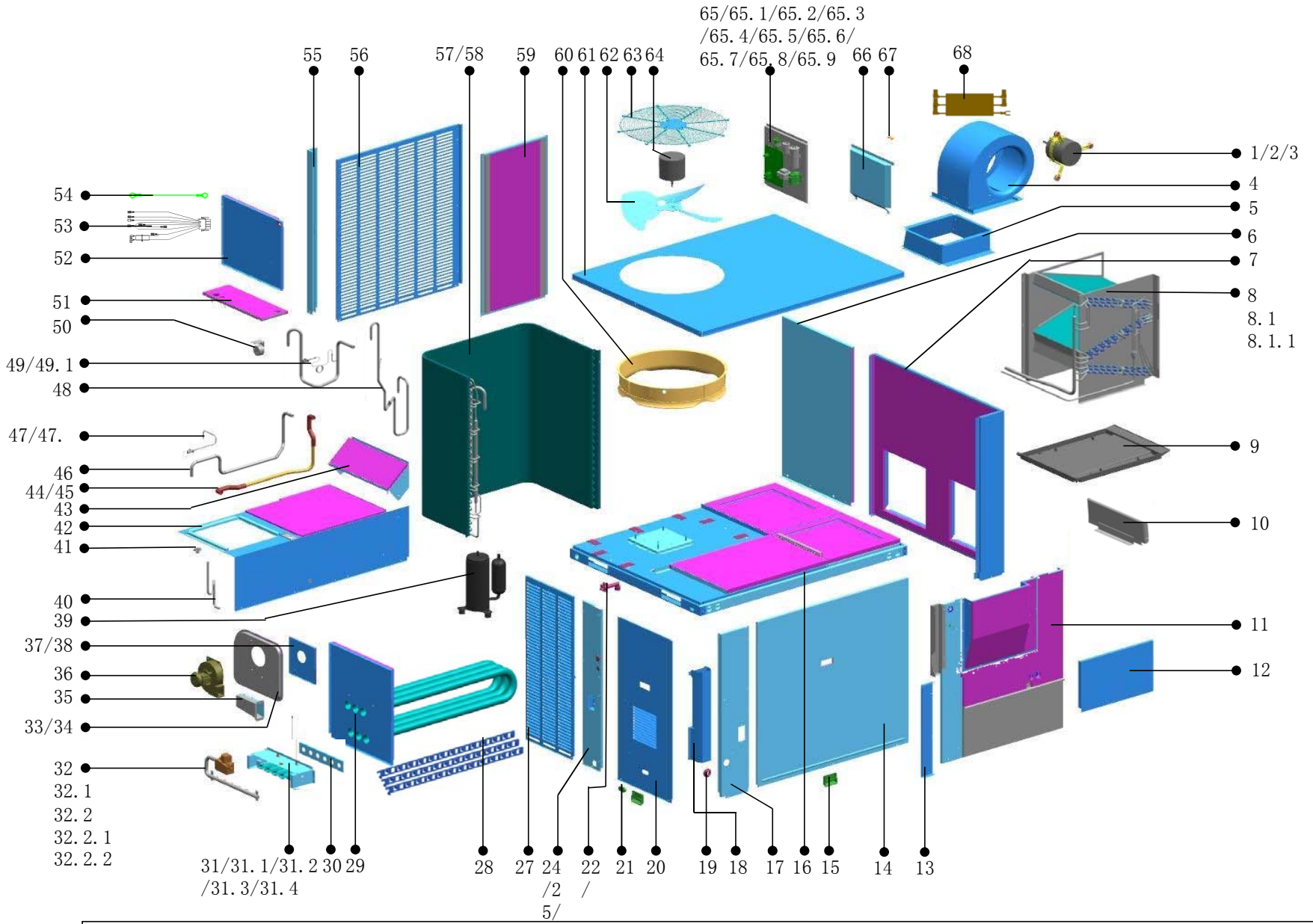

65.9 Compressor Capacitor

65.8 Indoor Fan Capacitor

65.7 Outdoor Fan Capacitor

65.6 Wire joint 2P

65.4 Transformer

65.2 50N02-400 pcb

65.3 AC contactor

65.5 Terminal block 6P

65.1



1	单相异步电机 (RoHS)	Motor	1	202400401827	0	
2	电机支架组件I (RoHS)	Motor bracket I	3	201270390288	0	
3	电机支架 II (RoHS)	Motor bracket II	1	201270390273	0	
4	离心风机 (RoHS)	Centrifugal fan	1	201200300865	0	
5	内外机隔板 I 组件 (RoHS)	Partition board I ass'y	1	201296090408	0	
6	风轮底座焊合件 (RoHS)	Wind wheel base	1	201296090397	0	
7	送回风面板组件 (SB3074, RoHS)	Panel ass'y	1	2012960A0346	0	
8	蒸发器部件 (C064) (RoHS)	Evaporator ass'y	1	201596090144	0	
8.1	蒸发器输入管组件 (阀芯C064)	Evaporator input pipe ass'y	1	201696091209	0	
8.1.1	单向管道节流阀 (RoHS)	One-way throttle valve pipe	1	201600801049	0	
9	接水盘 (黑色, RoHS)	Drain pan	1	201196090006	0	
10	接水盘挡水板组件 (SB3074, RoHS)	Drain pan baffle ass'y	1	201296090887	0	
11	内外机隔板 II 组件 (RoHS)	Partition board II ass'y	1	201296090402	0	
12	送回风隔板 I 组件 (RoHS)	Partition board I ass'y	1	201296090400	0	
13	中隔板 (RoHS)	Partition board	1	201296090442	0	
14	送风侧盖板组件 (SB3074, RoHS)	Cover plate ass'y	1	2012960A0341	0	
15	提手 (S3025) (RoHS)	Handle	2	201148700003	0	
16	底盘部件 (SB3074, RoHS)	Chassis ass'y	1	2012960A0348	0	
17	排烟盖板组件 (SB3074, RoHS)	Discharge smoke cover board	1	2012960A0362	0	
18	附件-烟道组件 (SB3074, RoHS)	Flue ass'y	1	2012960A0337	0	
19	附件-燃气管橡胶圈 (RoHS)	Gas tube rubber ring	1	202782290007	0	
20	电控前盖板 (SB3074, RoHS)	Electronic control box front cover	1	2012960A0356	0	
21	长形透明塑料盖 (RoHS)	Long-shaped transparent plastic cover	1	201182290002	0	
22	出水接头 (黑色, RoHS)	Water outlet joint	1	201196090002	0	
23	封口塞 (RoHS)	Sealing plug	1	201170390002	0	
24	表接头安装盒连接板焊合件	Meter connector mounting box junction	1	2012960A0502	0	
25	冷凝器密封板1 (SB3074, RoHS)	Condenser sealplate 1	1	2012960A0334	0	
26	冷凝器密封板2 (SB3074, RoHS)	Condenser sealplate 2	1	2012960A0333	0	
27	外侧面板组件2 (SB3074, RoHS)	Outside panel 2	1	201296090914	0	
28	扰流片 (RoHS)	Spoiler	3	201296090446	0	
29	换热管部件 (RoHS)	Heat exchange tube ass'y	1	201296090477	0	
30	导流板 (RoHS)	Deflector	1	201296090444	0	
31	燃烧器组件 (RoHS)	Burner ass'y	1	201296090475	0	
31.1	点火针 (CSA)	Firing pin	1	202319900978	0	
31.2	火焰传感器	Flame sensor	1	202301300524	0	
31.3	温控器 (手动复位) (RoHS) (C064)	Thermostat	1	202301600544	0	
31.4	燃烧器	Burner	3	202419900251	0	
32	燃气管部件 (RoHS)	Gas pipe ass'y	1	201696090708	0	
32.1	燃气阀	Gas valve	1	201601601252	0	
32.2	燃气管组件 (RoHS)	Gas pipe ass'y	1	201696090709	0	
32.2.1	燃气管	Gas pipe	1	201696091034	0	
32.2.2	铜喷嘴	Copper nozzle	3	201600401186	0	
33	集气罩 (RoHS)	Hoodforfumes	1	201296090443	0	
34	集气罩玻纤垫 (RoHS)	Hoodforfumes Glass fiber pad	1	202196090100	0	
35	烟道转接口组件 (RoHS)	Flue transfer interface	1	201296090377	0	
36	排烟风机组件 (UL)	Exhaust fan ass'y	1	202400505717	0	
37	排烟挡板 (RoHS) (1个标识)	Exhaust baffle	1	201296090464	0	
38	排烟挡板玻纤垫 (RoHS)	Exhaust baffle glass fiber pad	1	202196090099	0	
39	压缩机 (GMCC) (RoHS)	Compressor	1	201400611177	0	
40	内侧排水管 (RoHS)	Drain pipe	1	201696090661	0	
41	温控器 (RoHS) (UL)	Thermostat	1	202301600542	0	

42	风道部件 (RoHS)	Air flue	1	201296090410	0	
43	送回风隔板 II 组件 (RoHS)	Partition board II ass'y	1	201296090398	0	
44	外侧排水管 (RoHS)	Drain pipe	1	201696090617	0	
45	排水内连接管 (黑色, RoHS)	Connecting pipe	2	202796090005	0	
46	连接管 (RoHS)	Connection pipe	1	201696091194	0	
47	高压表接头组件 (ROHS)	High pressure meter connector ass'y	1	201696090723	0	
47.1	表接头 (RoHS)	Pipe joint	1	201601200011	0	
48	排气管组件 (RoHS)	Discharge pipe ass'y	1	201696091207	0	
49	回气管组件 (RoHS)	Suction pipe ass'y	1	201696091204	0	
49.1	表接头 (RoHS)	Pipe joint	1	201601200011	0	
50	风压传感器 (CSA)	Wind pressure switch	1	202301800130	0	
51	电控隔板组件 (RoHS)	Partition board ass'y	1	201296090388	0	
52	电控盒安装板组件 (RoHS)	Electronic control box installation board	1	201296090391	0	
53	信号连接线组 (RoHS)	Signal connection wire	1	202496090060	0	
54	接地线 (绿色) (RoHS)	ground wire	1	202402190055	0	
55	左立柱 (SB3074, RoHS)	Left upright column	1	2012960A0358	0	
56	外侧面板组件1 (SB3074, RoHS)	Outside panel ass'y 1	1	201296090872	0	
57	冷凝器部件 (微通道, 12mm)	Condenser ass'y	1	201596090142	0	
58	冷凝器密封板 (SB3074, RoHS)	Condenser sealplate 1	1	201296090886	0	
59	回风侧板组件 (SB3074, RoHS)	Side board ass'y	1	2012960A0344	0	
60	导风圈 (黑色, RoHS)	Ring	1	201196090007	0	
61	顶盖组件 (SB3074, RoHS)	Top cover ass'y	1	2012960A0339	0	
62	轴流风叶 (RoHS)	Axial fan	1	201200300868	0	
63	顶盖网罩 (ST3023, RoHS)	Top cover veil	1	201275490044	0	
64	异步电机 (RoHS)	Motor, 208/230V 60hz 1PH, 0.8A, 825RPM	1	202400400740	0	
65	屋顶机电控盒组件 (RoHS)	E-part box ass'y	1	203396090099	0	
65.1	电器安装板 (RoHS)	Installation board	1	201296090452	0	
65.2	电控主板	Electric motherboard	1	201319902702	0	
65.3	交流接触器 (限30A) (RoHS)	AC contactor	1	202300830522	0	
65.4	电源变压器 (无保险丝60Hz)	Transformer	1	202300900212	0	
65.5	六位接线座UL (RoHS)	Terminal block 6P	1	202301400219	0	
65.6	二位接线座 (RoHS, UL)	Wire joint, 2p	3	202301400220	0	
65.7	压缩机电容 (RoHS)	Capacitor	1	202401000891	0	
65.8	压缩机电容 (RoHS)	Compressor capacitor	1	202401000893	0	
65.9	压缩机电容 (RoHS)	Capacitor	1	202401000866	0	
66	附件-进气口盖板组件 (SB3074, RoHS)	Air intake cover ass'y	1	2012960A0335	0	
67	附件-铜喷嘴 (RoHS)	Copper nozzle	3	201600401161	0	
68	压缩机连接线组 (RoHS)	Compressor wire joint ass'y	1	202496090028	0	