

Market model: MRB-30HWN1-M14

product code: 220096000600

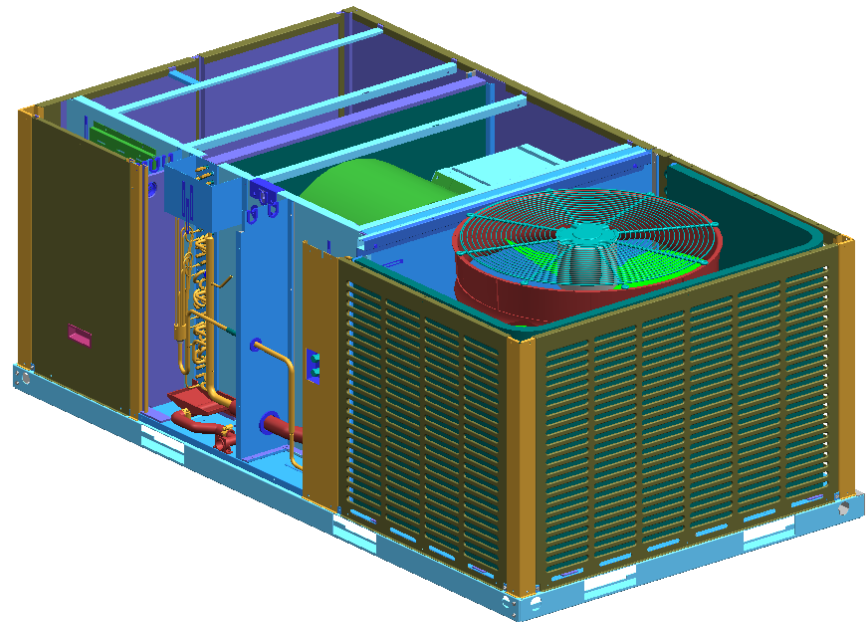

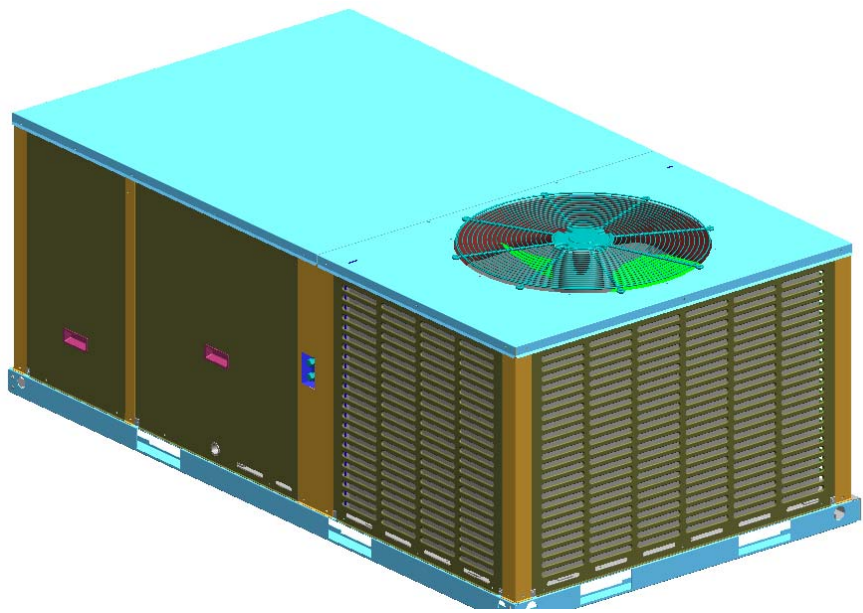
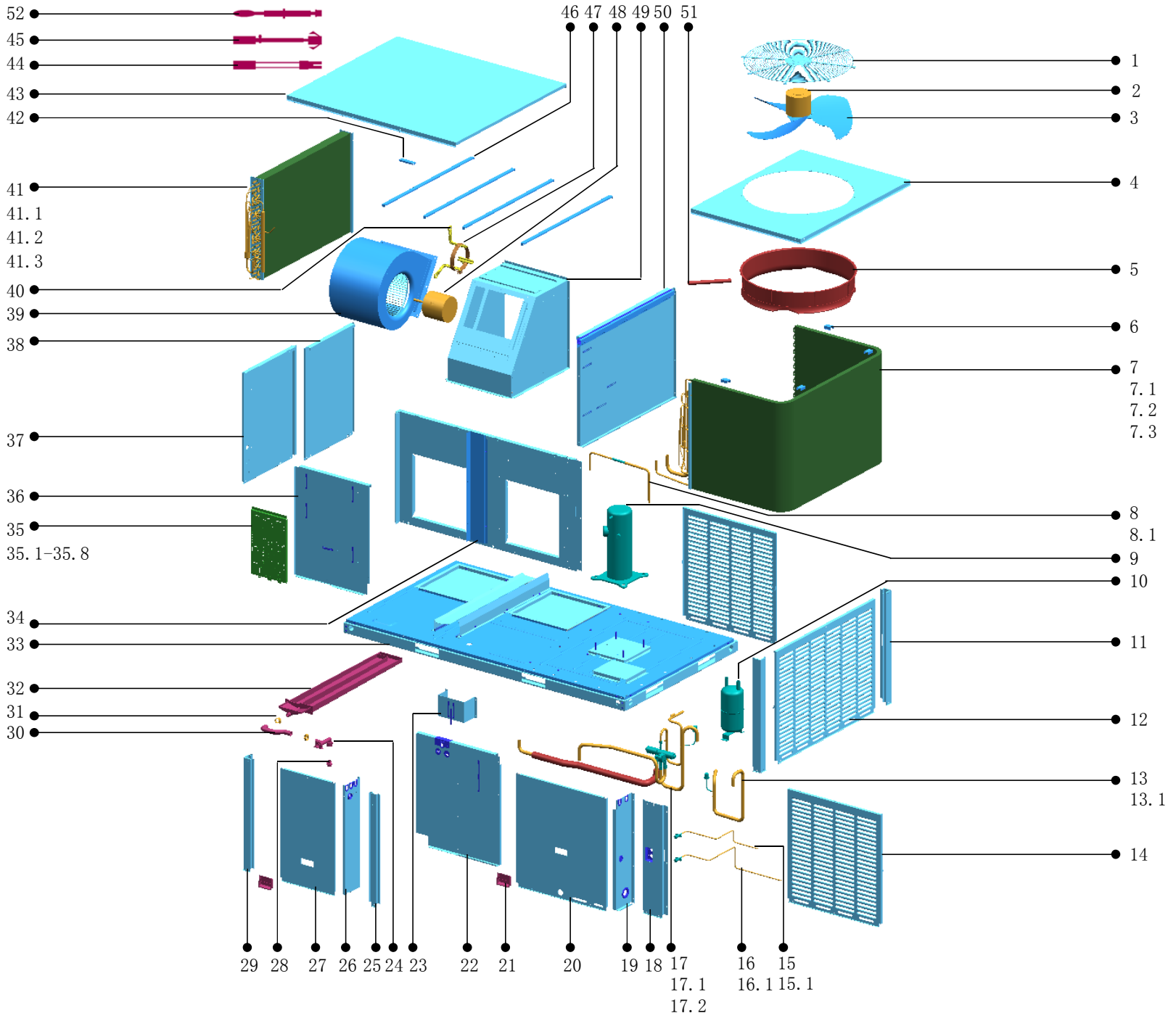

defrost jump

power in

transformer power line in

crankcase heater plug

outdoor fan plug

indoor fan(L) plug

indoor fan(H) plug

indoor fan(M) plug

reversing valve

compressor contactor control

pipe temperature

signal input

manal defrost

low pressure cut-off control

24v~ input

ambient temperature HLC and HGS input

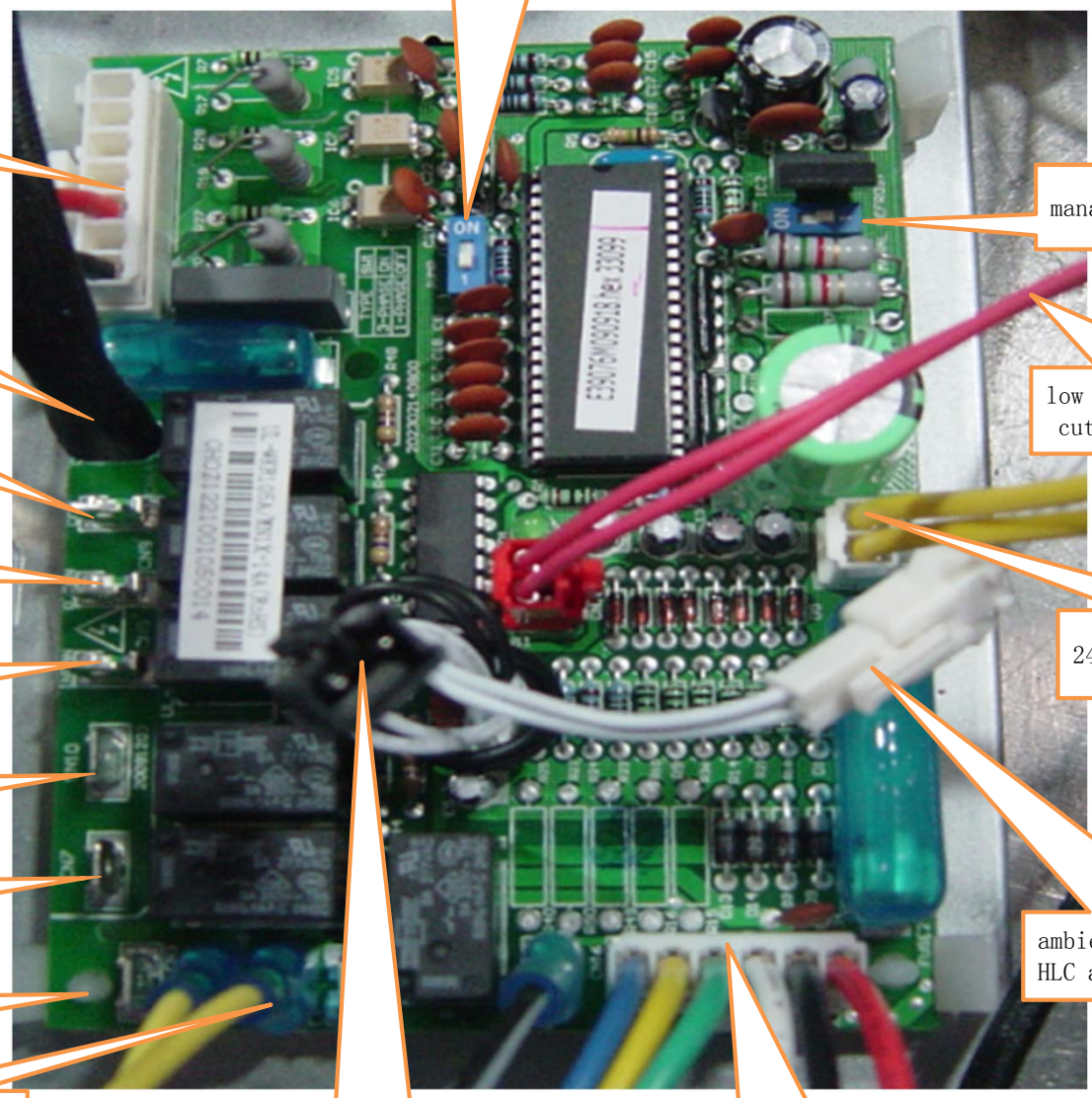

No.	中文	Part Name	Quantity	BOM code	Price(\$\$)	Remark
1	顶盖网罩 (SB3023, RoHS)	Top cover veil	1	201296090213		
2	异步电机 (RoHS)	Motor	1	202400400654		
3	轴流风叶 (RoHS)	Fan, 3 blade count, aluminum alloy + gal	1	201200300245		
4	外机顶盖焊合件 (SB3053, RoHS)	Top cover	1	201296090231		
5	导风圈 (RoHS)	Ring	1	201175590009		
6	冷凝器固定卡 (配1.5排Φ7)	Fixture clip	4	201275390114		
7	冷凝器部件 (RoHS)	Condenser ass'y	1	201596090053		
7.1	冷凝器 (亲水/1.3, RoHS)	Condenser	1	201596090037		
7.2	冷凝器输入管组件 (RoHS)	Condenser inlet pipe ass'y	1	201696090533		
7.3	冷凝器输出管组件 (RoHS)	Condenser output pipe ass'y	1	201696090526		
8	节流部件 (RoHS)	Throttle ass'y	1	201696090536		
8.1	双向管道节流阀 (RoHS)	Two-way pipe throttle valve	1	201600801299		
9	压缩机 (带附件) (谷轮) (RoHS)	Compressor	1	201401410060		
10	贮液筒 (RoHS)	Accumulator cylinder	1	201601000139		
11	右立柱 (SB3053, RoHS)	Pole	2	201296090303		
12	侧板1 (SB3053, RoHS)	Gridding	1	201296090312		
13	压缩机回气管组件 (RoHS)	Suction pipe ass'y	1	201696090321		
13.1	压力控制器 (RoHS)	Pressure switch	1	202301800837		
14	侧板2 (SB3053, RoHS)	Pole	2	201296090311		
15	高压表接头组件 (RoHS)	Pipe joint ass'y	1	201696090189		
15.1	表接头 (RoHS)	Pipe joint	1	201601200011		
16	低压表接头组件 (RoHS)	Pipe joint ass'y	1	201696090305		
16.1	表接头 (RoHS)	Pipe joint	1	201601200011		
17	四通阀组件 (RoHS)	4-way valve ass'y	1	201696090314		
17.1	四通阀套件 (RoHS)	4-Ways valve	1	201600630620		
17.2	压力控制器 (RoHS)	Pressure switch	1	202301800836		
18	表接头安装盒连接板焊合件	Pole	1	201296090126		
19	防水挡板组件 (RoHS)	waterproof clapboard ass'y	1	201296090297		
20	接水盘前盖板组件 (SB3053, RoHS)	Front cover plate ass'y	1	201296090309		
21	提手 (S3025) (RoHS)	Handle	2	201148700003		
22	蒸发器右连接板组件 (RoHS)	Evaporator right clapboard ass'y	1	201296090280		
23	挡线板组件 (RoHS)	Baffle ass'y	1	201296090208		
24	出水接头 (黑色, RoHS)	Water outlet joint	1	201196090002		
25	中间立柱组件 (SB3053, RoHS)	Pole ass'y	1	201296090299		
26	电控隔板组件 (RoHS)	E-part box board ass'y	1	201296090304		
27	电控前盖板 (SB3053, RoHS)	Front cover	1	201296090279		
28	封口塞 (RoHS)	Sealing plug	1	201170390002		
29	左立柱组件 (SB3053, RoHS)	pole ass'y	1	201296090301		
30	排水内连接管 (黑色, RoHS)	Connecting pipe	1	202796090005		
31	喉箍18-32 (RoHS)	Throat bander	2	202900240000		
32	接水盘部件 (黑色, RoHS)	Drainage pan ass'y	1	201196090004		
33	底盘部件 (SB3053, RoHS)	Base ass'y	1	201296090260		
34	送回风面板组件 (SB3053, RoHS)	Panel ass'y	1	201296090290		
35	屋顶机电控盒组件	E-part box ass'y	1	203396090045		
35.1	压缩机电容 (RoHS)	Compressor capacitor	1	202401000886		
35.2	压缩机电容 (RoHS)	Compressor capacitor	1	202401000893		
35.3	电源变压器 (无保险丝60Hz)	Transformer	1	202300900223		
35.4	室外主控板组件 (插件, RoHS)	Main control board ass'y	1	201396090005		
35.6	交流接触器24V (RoHS)	AC contactor 24V	1	202300830518		
35.7	八位接线座 (RoHS)	Wire joint, 8p	1	202301400226		
35.8	压缩机电容 (RoHS)	Capacitor	1	202401000891		

36	蒸发器左连接板组件 (RoHS)	Evaporator left clapboard ass'y	1	201296090283		
37	回风侧板 II 组件 (SB3053, RoHS)	cover ass'y II	1	201296090295		
38	回风侧板 I 组件 (SB3053, RoHS)	cover ass'y I	1	201296090293		
39	离心风机 (RoHS)	Centrifugal fan	1	201200300211		
40	电机支架组件 I (RoHS)	Motor bracket I	3	201270390288		
41	蒸发器部件 (RoHS)	Evaporator ass'y	1	201596090036		
41.1	蒸发器 (亲水/1.6, RoHS)	Evaporator	1	201596090038		
41.2	蒸发器输入管组件 (RoHS)	Evaporator input pipe ass'y	1	201696090340		
41.3	蒸发器输出管组件 (RoHS)	Evaporator output pipe ass'y	1	201696090353		
42	侧板支撑 (RoHS)	Clapboard supporting board	1	201296090225		
43	内机顶盖组件 (SB3053, RoHS)	Top cover ass'y	1	201296090233		
44	排气温控器 (RoHS)	Discharge Temp. sensor	1	202301610027		
45	管温传感器组件 (商用) (RoHS)	Pipe Temp. sensor ass'y	1	202301300438		
46	顶部横梁 (RoHS)	beam	4	201296090227		
47	电机支架 II (RoHS)	Motor bracket II	1	201270390273		
48	异步电机 (RoHS)	Induction motor	1	202400400584		
49	风道部件 (RoHS)	Duct components	1	201296090339		
50	内外机隔板组件 (RoHS)	Partition board ass'y	1	201296090287		
51	过线导管 (RoHS)	Pipe	1	201175490001		
52	室温传感器组件 (商用) (RoHS)	Room Temp. sensor ass'y	1	202301300198		
54	压缩机连接线组 (RoHS)	Compressor wire joint ass'y	1	202496090003		